

Technical Guide

# Underground

Underground Systems





Brett Martin is a multi-site international organisation producing not only an extensive range of plastic Underground, Rainwater and Plumbing systems but also Europe's largest range of GRP, PVC, Polycarbonate and Acrylic rooflight sheet products.

Our reputation for excellence in product quality and technical service is founded on over 60 years manufacturing experience.

# UNDERGROUND

## TECHNICAL GUIDE

Brett Martin offers a fully comprehensive range of Underground products, including pipes in up to 13 diameters, industry compliant fittings and a stormwater management system.

When selecting a Brett Martin Underground Drainage System you can be sure that every product has been designed with ease of installation in mind to offer the installer maximum choice and flexibility.

All products are manufactured to exacting standards through the company's achievement of BS EN ISO 9001:2015. You can be confident that as a BSI registered firm our Quality Assurance Programme guarantees that each Brett Martin system is a first class product, ensuring the highest possible levels of performance.

**PRODUCT CATALOGUE**

**INTRODUCTION**

Page

**6**

**STANDARDS  
& CERTIFICATIONS**

**7**

**PRODUCT INDEX**

DRAIN & SEWER PIPES	<b>8</b>
PERFORATED PIPES	<b>9</b>
COUPLINGS, SOCKETS & SLEEVES	<b>10</b>
SINGLE SOCKET BENDS	<b>11-12</b>
DOUBLE SOCKET BENDS	<b>12-13</b>
LONG RADIUS BENDS	<b>13</b>
BRANCHES	<b>14-16</b>
CLIP SADDLE BRANCHES	<b>17</b>
ADAPTORS	<b>18</b>
PLUGS	<b>19</b>
WASTE ADAPTORS	<b>19-20</b>
BOTTLE GULLY RANGE	<b>21-22</b>
GULLY RANGE	<b>22-23</b>
HOPPERS	<b>23-24</b>
GRID/SEALING PLATES	<b>24-25</b>
SHALLOW ACCESS CHAMBERS	<b>26-28</b>
INSPECTION CHAMBERS	<b>28-29</b>
CHANNEL PIPES & BENDS	<b>30-31</b>
CHANNEL BENDS	<b>32</b>
ROAD GULLIES	<b>33</b>
ACCESS FITTINGS	<b>33</b>
TWINWALL PIPES & FITTINGS	<b>34</b>
CABLE DUCTS	<b>35</b>
STORMCRATE ATTENUATION & INFILTRATION	<b>36</b>
RINGS & SUNDRIES	<b>36</b>

**TECHNICAL INFORMATION**

FUNCTION	<b>38</b>
AUTHORITY	<b>38</b>
STANDARDS	<b>38</b>
COMPOSITION	<b>38</b>
BIOLOGICAL AND CHEMICAL RESISTANCE	<b>38</b>
GENERAL RESISTANCES	<b>38</b>

**GENERAL INFORMATION**

STORAGE	<b>39</b>
HANDLING	<b>39</b>
TRANSPORT	<b>39</b>

**INSTALLATION**

Page

INSTALLATION – GENERAL POINTS	<b>40</b>
FLOW PROPERTIES	<b>40</b>
CHOICE OF GRADIENTS	<b>41</b>
PIPE SIZING	<b>41</b>
FLOW PROPERTIES – CLEAN SEWERS	<b>42</b>
FLOW PROPERTIES – MATURE SEWERS	<b>43</b>
FLOW PROPERTIES – ROUGH BORE	<b>44</b>
SPECIAL PROTECTION – GROUND LOADS	<b>45</b>
TRENCH PREPARATION	<b>45</b>
MATERIALS FOR BEDDING	<b>46</b>
EASE OF COMPACTION	<b>47</b>
PIPE LAYING	<b>47</b>
SPECIAL PROTECTION – SETTLEMENT	<b>48</b>
SPECIAL PROTECTION – SURCHARGING	<b>48</b>
ACCESS TO DRAINS	<b>49</b>
PREFORMED INSPECTION CHAMBERS	<b>50-51</b>
SHALLOW ACCESS CHAMBERS	<b>52</b>
ACCESS AND INSPECTION CHAMBERS	<b>53</b>
OPEN CHANNEL MANHOLES	<b>54</b>
BACKDROP MANHOLE CONSTRUCTION	<b>55</b>
RODDING ACCESS	<b>56</b>
HEAD OF DRAIN RODDING POINT	<b>56</b>
UNIVERSAL RODDABLE BOTTLE GULLY	<b>57</b>
RODDING ACCESS	<b>57</b>
TYPICAL LAYOUT USING RODDING	
ACCESS COMPONENTS	<b>57</b>
TYPICAL INSTALLATION (ENGLAND & WALES)	<b>58</b>
TRADITIONAL GULLY ASSEMBLY	<b>58</b>
HORIZONTAL BACK INLET ASSEMBLY	<b>59</b>
BOTTLE GULLY ASSEMBLY	<b>59</b>
SOIL PIPE CONNECTION (SHORT RADIUS)	<b>59</b>
SOIL PIPE CONNECTION (LONG RADIUS)	<b>60</b>
RAINWATER PIPE CONNECTIONS	<b>60</b>
SADDLE BRANCH, BRANCH ENTRIES	<b>60</b>
PIPE JOINTS	<b>61</b>
CUTTING	<b>61</b>
PUSH-FIT JOINTING	<b>61</b>
PERFORATED PIPE	<b>62</b>
SOLVENT CEMENT JOINTING	<b>63</b>
CONNECTION TO UNDERGROUND DRAINAGE	<b>64</b>
MAINTENANCE	<b>64</b>
CHEMICAL RESISTANCES	<b>65-67</b>

<b>PRODUCT CATALOGUE</b>	Page
<b>INTRODUCTION</b>	<b>6</b>
<b>STANDARDS &amp; CERTIFICATIONS</b>	<b>7</b>
<b>PRODUCT INDEX</b>	
DRAIN & SEWER PIPES	<b>8</b>
PERFORATED PIPES	<b>9</b>
COUPLINGS, SOCKETS & SLEEVES	<b>10</b>
SINGLE SOCKET BENDS	<b>11-12</b>
DOUBLE SOCKET BENDS	<b>12-13</b>
LONG RADIUS BENDS	<b>13</b>
BRANCHES	<b>14-16</b>
CLIP SADDLE BRANCHES	<b>17</b>
ADAPTORS	<b>18</b>
PLUGS	<b>19</b>
WASTE ADAPTORS	<b>19-20</b>
BOTTLE GULLY RANGE	<b>21-22</b>
GULLY RANGE	<b>22-23</b>
HOPPERS	<b>23-24</b>
GRID/SEALING PLATES	<b>24-25</b>
SHALLOW ACCESS CHAMBERS	<b>26-28</b>
INSPECTION CHAMBERS	<b>28-29</b>
CHANNEL PIPES & BENDS	<b>30-31</b>
CHANNEL BENDS	<b>32</b>
ROAD GULLIES	<b>33</b>
ACCESS FITTINGS	<b>33</b>
TWINWALL PIPES & FITTINGS	<b>34</b>
CABLE DUCTS	<b>35</b>
STORMCRATE ATTENUATION & INFILTRATION	<b>36</b>
RINGS & SUNDRIES	<b>36</b>

# PRODUCT

## INTRODUCTION

Brett Martin offers fully comprehensive ranges of Underground Drain and Sewer Systems.

Pipes and Fittings are produced in six (OD) diameters, ranging from 110mm to 400mm. Both 110mm and 160mm pipe ranges are available in both SN4 and SN8 stiffness classes. The systems are manufactured under BS EN ISO 9001:2015 certification and tested to the requirements of BS EN 13598-1 and BS EN 1401-1 and many items carry the BSI Kitemark.

Brett Martin also offers a range of standard or heavy duty perforated land drainage pipes available in fourteen diameters ranging from 53.9mm to 600mm. Each pipe is supplied with an integral blown socket, cutting installation time to a minimum. A popular section of the range, is the Brett Martin Cable Duct system, ranging from 53.9mm to 200mm diameter. A super smooth bore, push fit blown sockets and a comprehensive range of bends and couplers make the Brett Martin Duct system easy and efficient to assemble.

The Brett Martin Drain, Sewer, Surface Water and Cable Duct systems form part of the vast range of quality products manufactured for the construction industry, and are among the leading Underground Systems now available.

Brett Martin has an ongoing programme of investment. You can be confident of well designed products combining ease of installation with high levels of performance efficiency.

## UNDERGROUND DRAINAGE PRODUCT GUIDE

The Brett Martin Underground Drainage Product Guide illustrates all the components which make up Brett Martin Underground Systems. Information relating to dimensions, performance, illustration, design and fitting are provided. The Brett Martin Underground Drainage Product Guide is a comprehensive manual for architect, specifier and builder alike.

## AVAILABILITY

Brett Martin Underground Systems are available from builders' merchants throughout the UK and Ireland. There is a direct to site delivery service available.

## CONDITIONS OF SALE

Brett Martin Underground Systems are sold subject to the Conditions of Sale, copies of which are available on request.

**STANDARDS**

Brett Martin Drainage systems are manufactured under the following British and European Standards:-

BS EN ISO 9001:2015 Quality Management Systems

BS EN 1401-1



Plastic piping systems for non-pressure underground drainage and sewerage. Unplasticized poly(vinyl chloride) (PVC-U). Part 1: Specifications for pipes, fittings and the system.

BS EN 13598-1:2010



Plastics piping systems for non-pressure underground drainage and sewerage. Unplasticized poly(vinyl chloride) (PVC-U), polypropylene (PP) and polyethylene (PE). Part 1: Specifications for ancillary fittings including shallow inspection chambers.

**PRODUCT CERTIFICATIONS**

The following Brett Martin Underground products have full BBA accreditation:

BBA 87/1898  
Product Sheet 1



110 mm Diameter PVC-U Surface Water Drainage Pipe and 110 mm and 160 mm Diameter Polypropylene Pipe Couplings, for use with pipe and fittings complying with BS EN 1401 :2009, underground for the conveyance of surface water.

BBA 87/1898  
Product Sheet 2



110mm Diameter PVC-U Drainage Pipe for use with pipe and fittings complying with BS EN 1401.

BBA 10/H168



Twinwall Drainage Fittings, for use in highway drainage in conjunction with BBA-certificated polyethylene twinwall highway drainage pipes (nominal sizes: 150 mm, 225 mm and 300 mm) and associated seals.

**INSTALLATION STANDARDS**

Drain and Sewer installations must be designed to comply with the following:

- The Building Regulations 2010, Approved Document H, Section H1
- Building (Scotland) Regulations 2004, Technical Handbook (Domestic & Non-Domestic) Section 3: Environment
- Building Regulations (Northern Ireland) 2012, Technical Booklet N, Section 3
- Building Regulations 2010, Technical Guidance Document H, Section 1.3 (ROI)

Comprehensive guidance on the design of drain and sewer systems is given in BS EN 752:2017 and BS5955: Part 6: 1980 Code of Practice for the Installation of Unplasticized PVC pipework for Gravity Drains and Sewers.

Following the recommendations of these codes is also deemed necessary to satisfy the requirements of the above Building Regulations.

All information in this Product Guide is based on the above documents, which should in any case be consulted for all installations.

**PIPE - PLAIN ENDED** 

CODE	SIZE	LENGTH	WALL THICKNESS
<b>B4001</b>	110mm	3m	3.2mm
<b>B4011</b>	110mm	6m	3.2mm
<b>B6001</b>	160mm	3m	4.1mm
<b>B6011</b>	160mm	6m	4.1mm
<b>B6001 SN8</b>	160mm	3m	4.7mm
<b>B6011 SN8</b>	160mm	6m	4.7mm
<b>B20300</b>	200mm	3m	4.9mm
<b>B20600</b>	200mm	6m	4.9mm
<b>B25300</b>	250mm	3m	6.1mm
<b>B25600</b>	250mm	6m	6.1mm
<b>B31300</b>	315mm	3m	7.7mm
<b>B31600</b>	315mm	6m	7.7mm
<b>B40300</b>	400mm	3m	9.8mm
<b>B40600</b>	400mm	6m	9.8mm

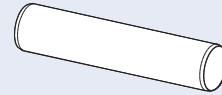
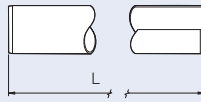

**PIPE - SINGLE SOCKET** 

CODE	SIZE	LENGTH	Y (Socket Length)
<b>B4403</b>	110mm	3m	70mm
<b>B4406</b>	110mm	6m	70mm
<b>B6603</b>	160mm	3m	95mm
<b>B6606</b>	160mm	6m	95mm
<b>B6603 SN8</b>	160mm	3m	95mm
<b>B6606 SN8</b>	160mm	6m	95mm
<b>B20003</b>	200mm	3m	110mm
<b>B20006</b>	200mm	6m	110mm
<b>B25003</b>	250mm	3m	140mm
<b>B25006</b>	250mm	6m	140mm
<b>B31003</b>	315mm	3m	155mm
<b>B31006</b>	315mm	6m	155mm
<b>B40003</b>	400mm	3m	215mm
<b>B40006</b>	400mm	6m	215mm

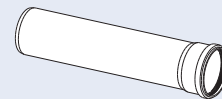
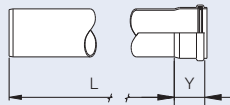

**PIPE - SINGLE SOCKET**

CODE	SIZE	LENGTH	Y (Socket Length)
<b>B4416</b>	110mm	6m	70mm

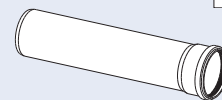
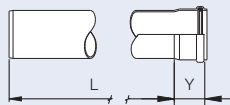

**SURFACE WATER PIPE - PLAIN ENDED**

CODE	SIZE	LENGTH
<b>B4121</b>	110mm	6m
<b>B6121</b>	160mm	6m

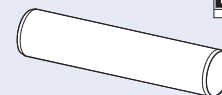
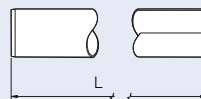

Manufactured in red oxide



**SURFACE WATER PIPE- SOCKETED**

CODE	SIZE	LENGTH	Y (Socket Length)
<b>B4122</b>	110mm	6m	70mm
<b>B6122</b>	160mm	6m	95mm

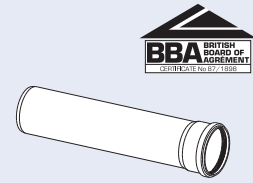
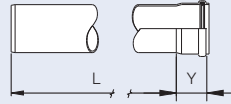

Manufactured in red oxide

**PERFORATED PIPE - BLOWN SOCKET  
(PIPETO BS 4660 / BS 5481)**

CODE	SIZE	LENGTH	WALL THICKNESS	HOLES PER M	°	Ø
<b>B4023</b>	110mm	6m	3.2mm	39	46°	6mm
<b>B6023</b>	160mm	6m	4.1mm	52	36°	6mm
<b>B8023</b>	200mm	6m	4.9mm	65	23°	6mm
<b>B40610</b>	400mm	6m	9.8mm	65	18°	8mm

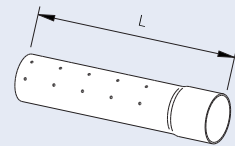

**PERFORATED PIPE - SINGLE SOCKET**

CODE	SIZE	LENGTH	WALL THICKNESS	HOLES PER M	°	Ø
<b>B4123</b>	110mm	6m	2.2mm	39	46°	6mm

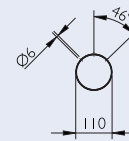

**Note:** UK codes B8023 and B40610 do not have a seal.

**POLYPROPYLENE PIPE COUPLER**

CODE	SIZE	LENGTH
<b>B4021</b>	110mm	95mm
<b>B6021</b>	160mm	130mm

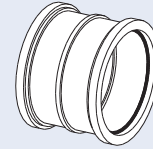
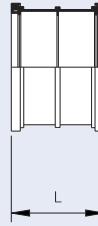

**PVC (BS) COUPLER** 

CODE	SIZE	LENGTH
<b>B5001</b>	110mm	135mm
<b>B7001</b>	160mm	175mm
<b>B20021</b>	200mm	225mm
<b>B25021</b>	250mm	265mm
<b>B31021</b>	315mm	300mm
<b>B40021</b>	400mm	370mm

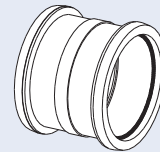
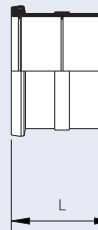

**PVC (SLIP) COUPLER** 

CODE	SIZE	LENGTH
<b>B5001/S</b>	110mm	135mm
<b>B7001/S</b>	160mm	175mm
<b>B20022</b>	200mm	225mm
<b>B25022</b>	250mm	270mm
<b>B31022</b>	315mm	310mm
<b>B40022</b>	400mm	560mm

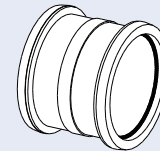
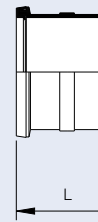

**SINGLE SOCKET COUPLER** 

CODE	SIZE	LENGTH
<b>B5011</b>	110mm	105mm
<b>B7011</b>	160mm	165mm

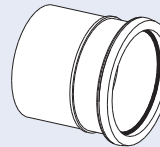

**SINGLE SOCKET BEND 87**  $1/2^\circ$  

CODE	SIZE	X	Y
<b>B5041</b>	110mm	163mm	150mm
<b>B7041</b>	160mm	223mm	230mm
<b>B20870</b>	200mm	535mm	535mm
<b>B25870</b>	250mm	609mm	695mm
<b>B31870</b>	315mm	458mm	453mm
<b>B40870</b>	400mm	750mm	765mm

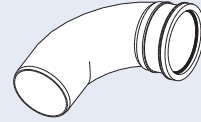
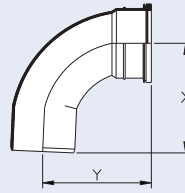

**SINGLE SOCKET BEND 67**  $1/2^\circ$  

CODE	SIZE	X	Y
<b>B5051</b>	110mm	128mm	169mm
<b>B7051</b>	160mm	183mm	235mm

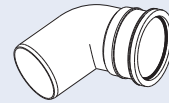
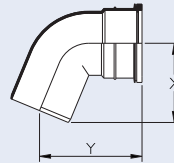

**SINGLE SOCKET BEND 45°** 

CODE	SIZE	X	Y
<b>B5061</b>	110mm	96mm	142mm
<b>B7061</b>	160mm	138mm	228mm
<b>B20450</b>	200mm	370mm	610mm
<b>B25450</b>	250mm	224mm	407mm
<b>B31450</b>	315mm	300mm	495mm
<b>B40450</b>	400mm	570mm	880mm

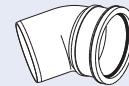
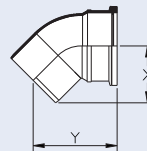

**SINGLE SOCKET BEND 30°** 

CODE	SIZE	X	Y
<b>B20030</b>	200mm	116mm	285mm
<b>B25030</b>	250mm	235mm	511mm
<b>B31030</b>	315mm	284mm	628mm
<b>B40030</b>	400mm	495mm	740mm

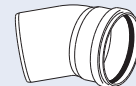
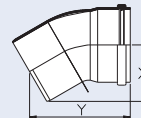

**SINGLE SOCKET BEND 22**  $1/2^\circ$  

CODE	SIZE	X	Y
<b>B5071</b>	110mm	78mm	149mm
<b>B7171</b>	160mm	113mm	234mm

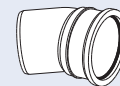
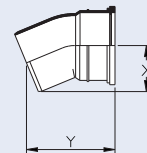

**SINGLE SOCKET BEND 15°** 

CODE	SIZE	X	Y
<b>B20015</b>	200mm	132mm	250mm
<b>B25015</b>	250mm	150mm	320mm
<b>B31015</b>	315mm	230mm	470mm
<b>B40015</b>	400mm	260mm	700mm

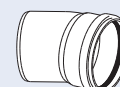
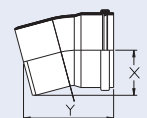

**SINGLE SOCKET BEND 11 1/4°** 

CODE	SIZE	X	Y
<b>B5081</b>	110mm	68mm	144mm
<b>B7181</b>	160mm	103mm	219mm

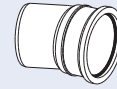
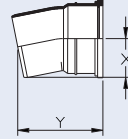

**SINGLE SOCKET BEND 0°- 30° ADJUSTABLE**

CODE	SIZE	X	Y
<b>B5030</b>	110mm	90mm	178mm

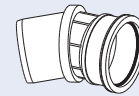
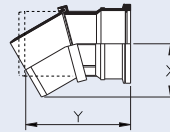

**DOUBLE SOCKET REST BEND 87 1/2° (LONG RADIUS)** 

CODE	SIZE	X	Y
<b>B4131</b>	110mm	241mm	263mm

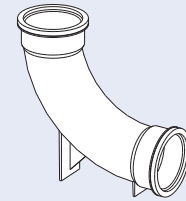
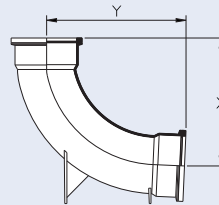

**DOUBLE SOCKET BEND 87 1/2°** 

CODE	SIZE	X	Y
<b>B4031</b>	110mm	156mm	150mm
<b>B6031</b>	160mm	223mm	228mm

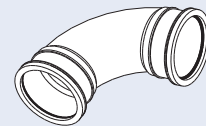
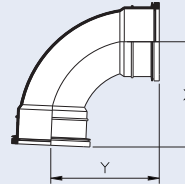

**DOUBLE SOCKET BEND 67 1/2°** 

CODE	SIZE	X	Y
<b>B4071</b>	110mm	143mm	173mm
<b>B6071</b>	160mm	187mm	228mm

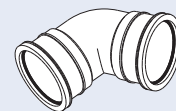
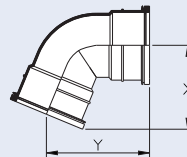

**DOUBLE SOCKET BEND 45°** 

CODE	SIZE	X	Y
<b>B4041</b>	110mm	104mm	143mm
<b>B6041</b>	160mm	163mm	231mm

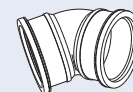
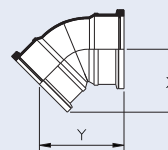

# DOUBLE SOCKET BENDS LONG RADIUS BENDS (PLAIN ENDED AND SINGLE SOCKETED)

## DOUBLE SOCKET BEND 22 1/2°

CODE	SIZE	X	Y
<b>B4051</b>	110mm	88mm	149mm
<b>B6051</b>	160mm	133mm	227mm

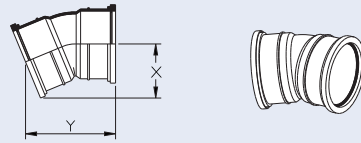

## DOUBLE SOCKET BEND 11 1/4°

CODE	SIZE	X	Y
<b>B4061</b>	110mm	78mm	147mm
<b>B6061</b>	160mm	123mm	221mm

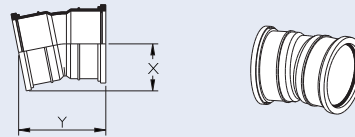

## DOUBLE SOCKET BEND 0°- 30° ADJUSTABLE BEND

CODE	SIZE	X	Y
<b>B4030</b>	110mm	104mm	181mm

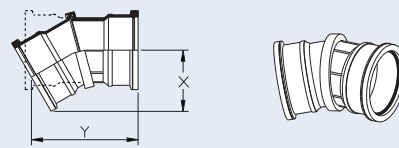

## LONG RADIUS BEND 87 1/2°

CODE P/E	CODE S/S	SIZE	RADIUS
<b>B5031</b>	<b>5930</b>	110mm	400mm
<b>B7021</b>	<b>7921</b>	160mm	610mm

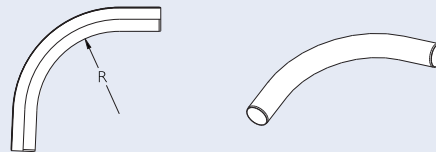

Plain-ended version shown

## LONG RADIUS BEND 45°

CODE P/E	CODE S/S	SIZE	RADIUS
<b>B5032</b>	<b>5931</b>	110mm	400mm
<b>B7022</b>	<b>7922</b>	160mm	610mm

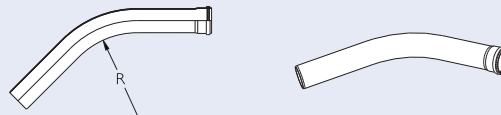

Single-socketed version shown

## LONG RADIUS BEND 22 1/2°

CODE P/E	CODE S/S	SIZE	RADIUS
<b>B5033</b>	<b>5932</b>	110mm	400mm
<b>B7023</b>	<b>7923</b>	160mm	610mm

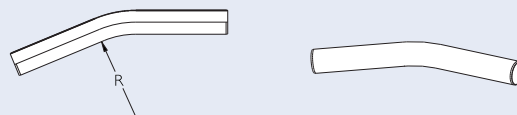

Plain-ended version shown

## LONG RADIUS BEND 11 1/4°

CODE P/E	CODE S/S	SIZE	RADIUS
<b>B5034</b>	<b>5933</b>	110mm	400mm
<b>B7024</b>	<b>7924</b>	160mm	610mm

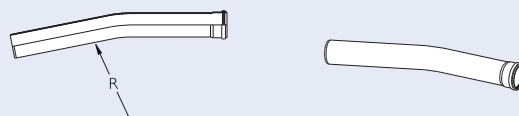

Single-socketed version shown

**110mm 87<sup>1</sup>/<sub>2</sub>° TRIPLE SOCKET BRANCH** 

CODE	SIZE	X	Y
<b>B4081</b>	110mm X 110mm dia.	135mm	145mm
<b>B7092</b>	160mm X 110mm dia.	223mm	228mm

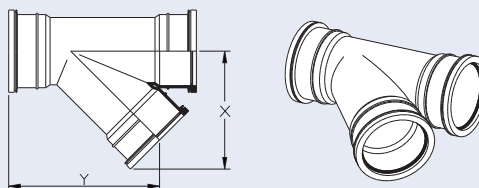

**160mm 87<sup>1</sup>/<sub>2</sub>° TRIPLE SOCKET BRANCH** 

CODE	SIZE	X	Y
<b>B6081</b>	160mm X 160mm dia.	223mm	228mm

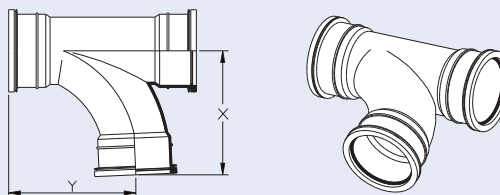

**110mm 45° TRIPLE SOCKET BRANCH** 

CODE	SIZE	X	Y
<b>B4091</b>	110mm X 110mm dia.	188mm	244mm
<b>B7102</b>	160mm X 110mm dia.	223mm	300mm

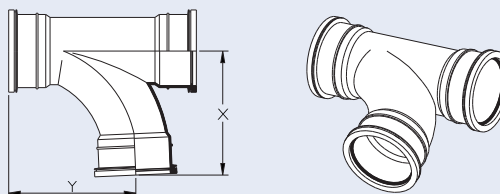

**160mm 45° TRIPLE SOCKET BRANCH** 

CODE	SIZE	X	Y
<b>B6091</b>	160mm X 160mm dia.	298mm	333mm

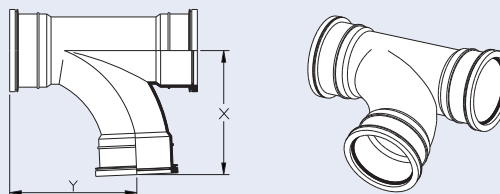

**110mm 87<sup>1</sup>/<sub>2</sub>° DOUBLE SOCKET BRANCH** 

CODE	SIZE	X	Y
<b>B5101</b>	110mm X 110mm dia.	135mm	150mm
<b>B7091</b>	160mm X 110mm dia.	223mm	223mm
<b>B20118</b>	200mm X 110mm dia.	240mm	380mm
<b>B25118</b>	250mm X 110mm dia.	250mm	325mm
<b>B31118</b>	315mm X 110mm dia.	310mm	370mm
<b>B40118*</b>	400mm X 110mm dia.	345mm	465mm

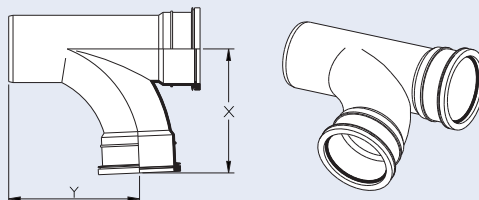

**160mm 87<sup>1</sup>/<sub>2</sub>° DOUBLE SOCKET BRANCH** 

CODE	SIZE	X	Y
<b>B7111</b>	160mm X 160mm dia.	223mm	224mm
<b>B20168</b>	200mm X 160mm dia.	305mm	310mm
<b>B25168</b>	250mm X 160mm dia.	310mm	365mm
<b>B31168</b>	315mm X 160mm dia.	363mm	427mm
<b>B40168*</b>	400mm X 160mm dia.	405mm	485mm

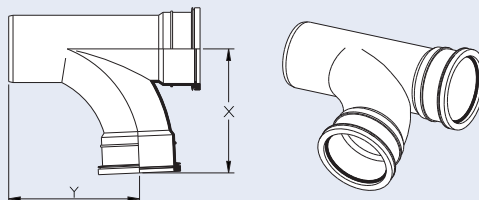

\*Not kitemarked

**200mm 87<sup>1</sup>/<sub>2</sub>° DOUBLE SOCKET BRANCH** 

CODE	SIZE	X	Y
<b>B20208</b>	200mm X 200mm dia.	395mm	405mm
<b>B25208</b>	250mm X 200mm dia.	460mm	470mm
<b>B31208</b>	315mm X 200mm dia.	400mm	475mm
<b>B40208*</b>	400mm X 200mm dia.	440mm	475mm

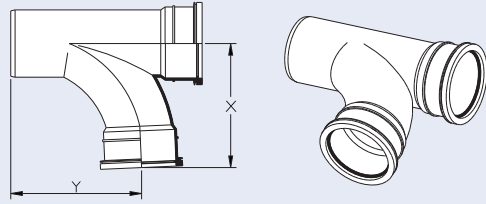

**250mm 87<sup>1</sup>/<sub>2</sub>° DOUBLE SOCKET BRANCH** 

CODE	SIZE	X	Y
<b>B25258</b>	250mm X 250mm dia.	445mm	453mm
<b>B31258</b>	315mm X 250mm dia.	490mm	550mm
<b>B40258*</b>	400mm X 250mm dia.	565mm	720mm

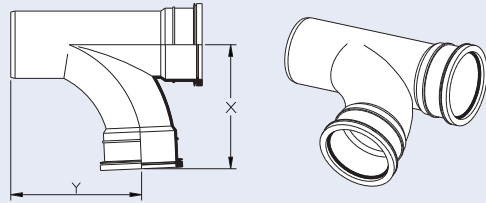

**315mm 87<sup>1</sup>/<sub>2</sub>° DOUBLE SOCKET BRANCH** 

CODE	SIZE	X	Y
<b>B31318</b>	315mm X 315mm dia.	570mm	670mm
<b>B40318*</b>	400mm X 315mm dia.	710mm	720mm

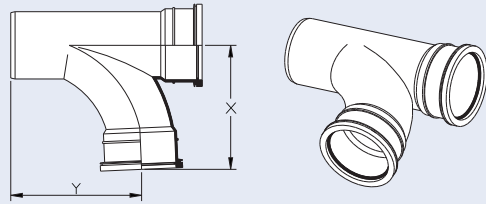

**400mm 87<sup>1</sup>/<sub>2</sub>° DOUBLE SOCKET BRANCH**

CODE	SIZE	X	Y
<b>B40408</b>	400mm X 400mm dia.	725mm	645mm

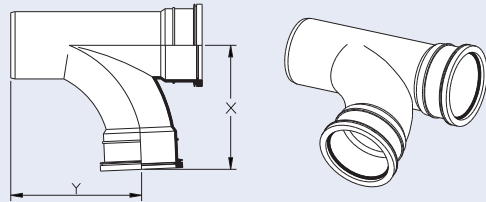

**110mm 45° DOUBLE SOCKET BRANCH** 

CODE	SIZE	X	Y
<b>B5111</b>	110mm X 110mm dia.	188mm	252mm
<b>B7101</b>	160mm X 110mm dia.	223mm	296mm
<b>B20110</b>	200mm X 110mm dia.	227mm	285mm
<b>B25110</b>	250mm X 110mm dia.	269mm	380mm
<b>B31110</b>	315mm X 110mm dia.	315mm	432mm
<b>B40110*</b>	400mm X 110mm dia.	345mm	560mm

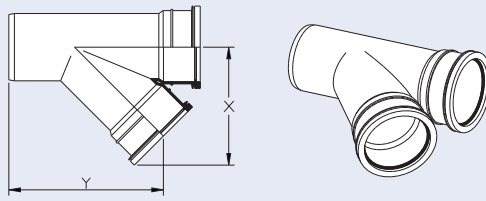

**160mm 45° DOUBLE SOCKET BRANCH** 

CODE	SIZE	X	Y
<b>B7121</b>	160mm X 160mm dia.	298mm	329mm
<b>B20160</b>	200mm X 160mm dia.	287mm	355mm
<b>B25160</b>	250mm X 160mm dia.	349mm	440mm
<b>B31160</b>	315mm X 160mm dia.	340mm	482mm
<b>B40160</b>	400mm X 160mm dia.	410mm	575mm

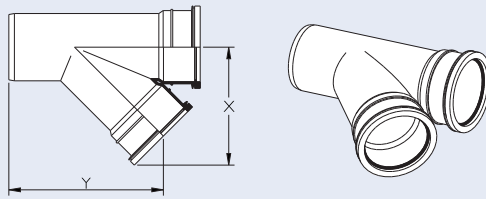

\*Not kitemarked

**200mm 45° DOUBLE SOCKET BRANCH** 

CODE	SIZE	X	Y
<b>B20200</b>	200mm X 200mm dia.	307mm	405mm
<b>B25200</b>	250mm X 200mm dia.	389mm	435mm
<b>B31200</b>	315mm X 200mm dia.	360mm	525mm
<b>B40200</b>	400mm X 200mm dia.	420mm	550mm

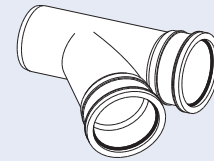
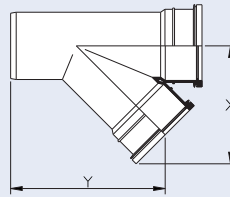

**250mm 45° DOUBLE SOCKET BRANCH** 

CODE	SIZE	X	Y
<b>B25250</b>	250mm X 250mm dia.	459mm	540mm
<b>B31250</b>	315mm X 250mm dia.	445mm	617mm
<b>B40250*</b>	400mm X 250mm dia.	500mm	750mm

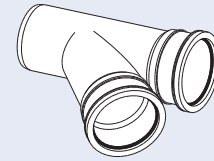
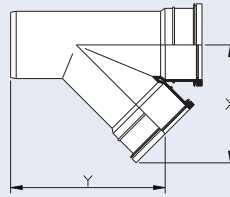

**315mm 45° DOUBLE SOCKET BRANCH** 

CODE	SIZE	X	Y
<b>B31315</b>	315mm X 315mm dia.	480mm	760mm
<b>B40315*</b>	400mm X 315mm dia.	550mm	800mm

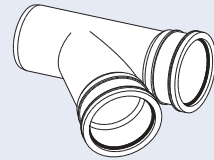
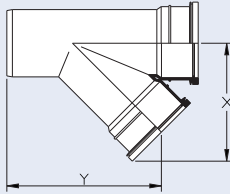

**400mm 45° DOUBLE SOCKET BRANCH** 

CODE	SIZE	X	Y
<b>B40400*</b>	400mm X 400mm dia.	600mm	850mm

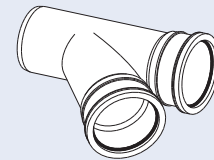
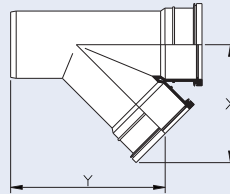

\*Not kitemarked



**SOLVENT WELD 87 1/2°** 

CODE	SIZE	LENGTH
<b>B7007</b>	110mm X 110mm dia.	200mm
<b>B7008</b>	160mm X 110mm dia.	305mm
<b>B7009</b>	160mm X 160mm dia.	305mm

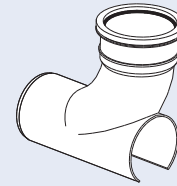
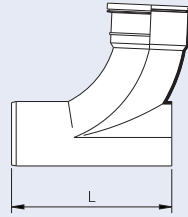

**SOLVENT WELD 45°** 

CODE	SIZE	LENGTH
<b>B7002</b>	110mm X 110mm dia.	245mm
<b>B7003</b>	160mm X 110mm dia.	325mm
<b>B7004</b>	160mm X 160mm dia.	325mm

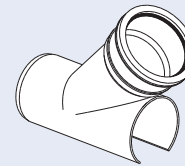
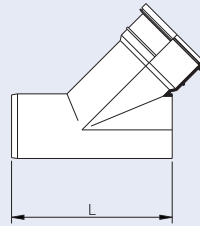

The following Clip Saddle Branches are available on request

	<b>200mm</b>	<b>250mm</b>	<b>315mm</b>	<b>400mm</b>
Solvent 90° - Dia Branch 110mm	B20111	B25111	B31111	B40111
Solvent 90° - Dia Branch 160mm	B20161	B25161	B31161	B40161
Solvent 90° - Dia Branch 200mm	B20120	B25120	B31120	B40120
Solvent 90° - Dia Branch 250mm		B25125	B31125	B40125
Solvent 90° - Dia Branch 315mm				B40135
Solvent 90° - Dia Branch 400mm				B40140

**SALT GLAZE SOCKET ADAPTOR**

CODE	SIZE	X
<b>B5131</b>	110mm	115mm
<b>B7161</b>	160mm	200mm
<b>B20108</b>	200mm	210mm
<b>B25108</b>	250mm	570mm
<b>B31108</b>	315mm	570mm
<b>B40108</b>	400mm	640mm

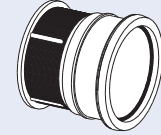
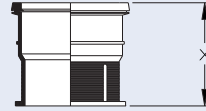

**SALT GLAZE SPIGOT ADAPTOR**

CODE	SIZE	X	Y
<b>B5141</b>	110mm	150mm	80mm
<b>B7151</b>	160mm	170mm	115mm
<b>B20109</b>	200mm	250mm	155mm
<b>B25109</b>	250mm	600mm	155mm
<b>B31109</b>	315mm	600mm	195mm
<b>B40109</b>	400mm	800mm	260mm

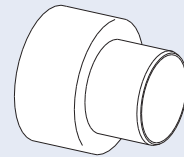
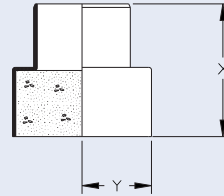

**PVCu TO STANDARD CLAY ADAPTOR**

CODE	SIZE	X	Y
<b>B3500</b>	110mm	135mm	165mm

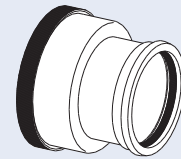
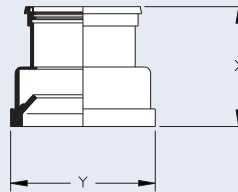

**PVCu TO SUPER CLAY ADAPTOR**

CODE	SIZE	X	Y
<b>B3510</b>	110mm	135mm	165mm

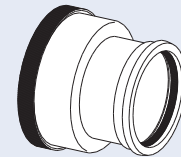
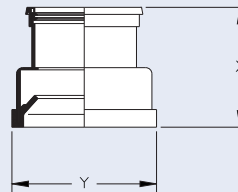

**LEVEL INVERT TAPER (Reduces to next diameter down)**



CODE	SIZE	X
<b>B7131</b>	110mm X 160mm	185mm
<b>B20112</b>	160mm X 200mm	250mm
<b>B25113</b>	200mm X 250mm	310mm
<b>B31114</b>	250mm X 315mm	360mm
<b>B40115</b>	315mm X 400mm	470mm

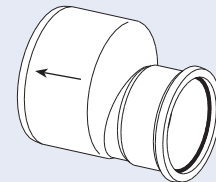
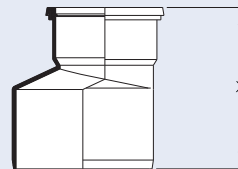

Puddle Flange 160mm code B7191 available on request

**TEMPORARY PIPE PLUG**

CODE	SIZE	LENGTH
<b>B5120</b>	110mm	71mm

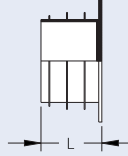

**PERMANENT PIPE PLUG**

CODE	SIZE	LENGTH
<b>B5122</b>	110mm	71mm

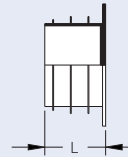

**SOCKET PLUG** 

CODE	SIZE	LENGTH
<b>B5121</b>	110mm	70mm
<b>B7141</b>	160mm	69mm
<b>B20141</b>	200mm	105mm
<b>B25141</b>	250mm	135mm
<b>B31141</b>	315mm	152mm
<b>B40141</b>	400mm	270mm

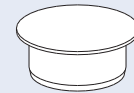
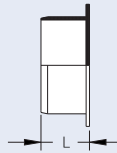

**PUSH-FIT WASTE ADAPTOR**

CODE	SIZE
<b>B4101</b>	32mm
<b>B4201</b>	40mm
<b>B4301</b>	50mm

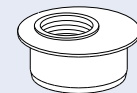

**50mm SOLVENT WELD WASTE ADAPTOR**

CODE	SIZE
<b>B4501</b>	76mm

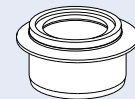
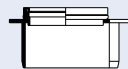

**32mm X 32mm SOLVENT WELD WASTE ADAPTOR**

CODE	SIZE
<b>B4601</b>	32mm X 32mm

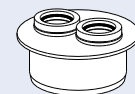
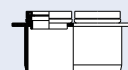

**32mm X 40mm SOLVENT WELD WASTE ADAPTOR**

CODE                      SIZE  
**B4701**                      32mm X 40mm

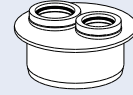
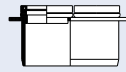

**110mm TO 68mm RAINWATER ADAPTOR**

CODE                      A                      B                      C                      D                      E  
**BR223B**                      139mm                      110mm                      43mm                      40mm                      68mm

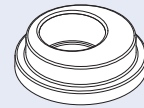
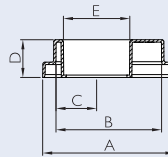

(Can be used to connect to both pipe spigot and a fitting socket. Available in Black only. For 65mm Square pipe, also use code BR517)

**UNIVERSAL ADAPTOR (PIPE)**

(Use rainwater adaptor to BR517 to connect to square pipe)

CODE                      SIZE  
**B4801**                      110mm

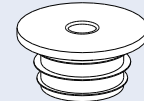
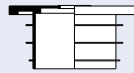

**UNIVERSAL ADAPTOR (SOCKET)**



CODE                      SIZE  
**B4901**                      110mm

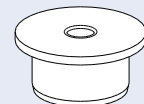

**BACK INLET RODDABLE GULLY 90° OUTLET ROUND GRID**

CODE	SIZE	X	Y	Z
<b>B1001</b>	110mm	286mm	151mm	250mm

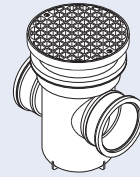
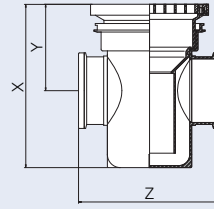

**BACK INLET RODDABLE GULLY 90° OUTLET RECTANGULAR GRID**

(pedestrian areas only)

CODE	SIZE	X	Y	Z
<b>B1002</b>	110mm	308mm	173mm	250mm

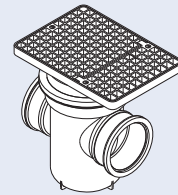
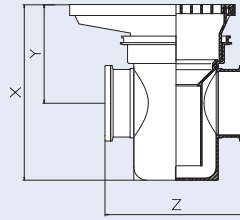

**BACK INLET RODDABLE GULLY 90° OUTLET SQUARE GRID**

(pedestrian areas only)

CODE	SIZE	X	Y	Z
<b>B1003</b>	110mm	348mm	212mm	250mm

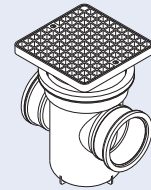
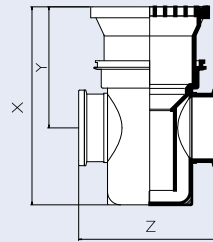

**SPARE ROUND HOPPER AND GRID**

CODE	SIZE	X	Y
<b>B1004</b>	110mm	207mm	78mm

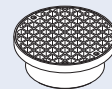
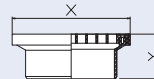

**SPARE RECTANGULAR HOPPER AND GRID**

(pedestrian areas only)

CODE	SIZE	X	Y
<b>B1005</b>	110mm	290mm	100mm

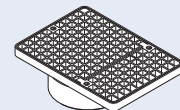
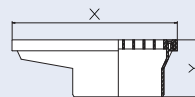

**SPARE SQUARE HOPPER AND GRID**

CODE	X	Y	Z
<b>B1006</b>	207mm	139mm	160mm

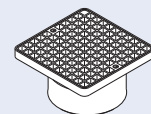
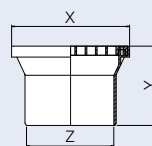

**RAISING PIECE FOR BACK INLET GULLY**

CODE	SIZE	X
<b>B1007</b>	110mm	200mm

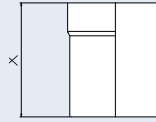

**PAVING COLLAR**

(Use with Square Hopper - code 1006)

CODE	SIZE	X	Y
<b>B1008</b>	110mm	304mm	90mm

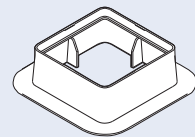
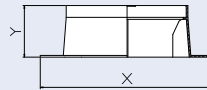

**SPARE RUBBER RING**

CODE	SIZE
<b>B1043</b>	110mm



**ROUND TO SQUARE ADAPTOR**

CODE	SIZE
<b>B1042</b>	200mm

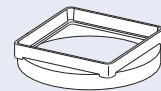

**300mm X 600mm TRAPPED YARD GULLY**

CODE	SIZE	X	Y
<b>B6300</b>	110mm	300mm	600mm

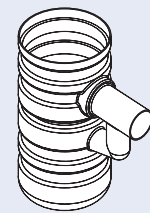

**ALUMINIUM SILT BUCKET**

CODE	SIZE
<b>B6301</b>	110mm

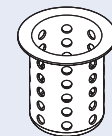

**HEAVY DUTY GRATING TO BS EN 124 CLASS C250kN**

CODE	SIZE
<b>B6302</b>	110mm

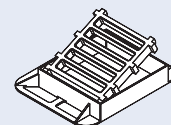

## GULLY RANGE HOPPERS (including Grid)

### LOWTRAPPED GULLY

CODE	SIZE	X	Y
<b>B1013</b>	110mm	213mm	218mm

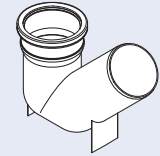
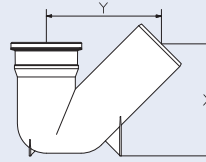

### P SOCKET LOWTRAPPED GULLY

CODE	SIZE	X	Y
<b>B1301</b>	110mm	235mm	330mm

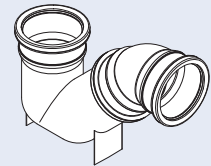
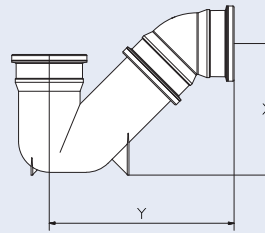

### INTEGRAL RECTANGULAR HOPPER

CODE	SIZE	X	Y	Z
<b>B1031</b>	110mm	225mm	275mm	125mm

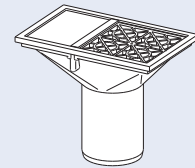
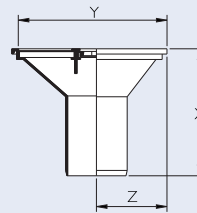

### ROUND HOPPER (200mm x 110mm)

CODE	SIZE	X	Y	Z
<b>B1021</b>	110mm	245mm	215mm	107.5mm

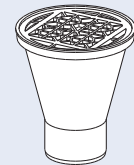
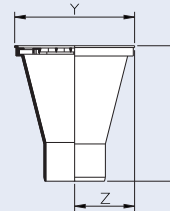

### SQUARE HOPPER (160mm X 110mm)

CODE	SIZE	X	Y	Z
<b>B1071</b>	110mm	240mm	160mm	80mm

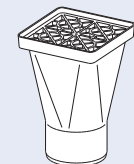
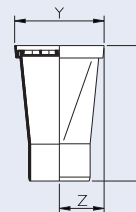

# HOPPERS (including Grid) HOPPERS (with Horizontal Socket Inlet)

## SQUARE HOPPER (160mm X 160mm) WITH 110mm SOLVENT SOCKET



CODE	SIZE	X	Y
<b>B1061</b>	110mm	104mm	160mm

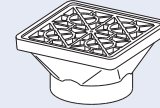
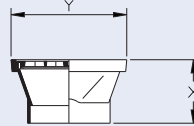

## SQUARE HOPPER RISER

CODE	SIZE	X	Y
<b>B1078</b>	110mm	150mm	80mm

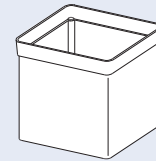
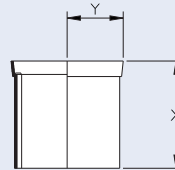

## 1 INLET ROUND HOPPER (200mm with 110mm Inlet)

CODE	SIZE
<b>B1022</b>	110mm

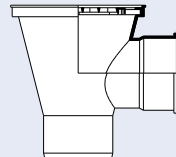

## 1 INLET SQUARE HOPPER (160mm with 110mm Inlet)

CODE	SIZE
<b>B1077</b>	110mm

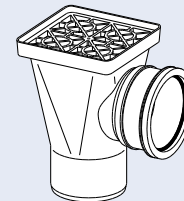
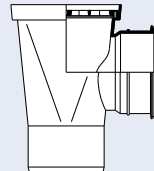

## DISHED GRATE - ALLOY SQUARE

CODE	X	Y
<b>B9131</b>	160mm	160mm

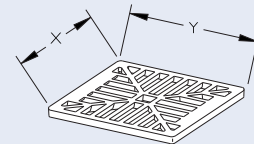

## DISHED GRATE - PLASTIC SQUARE

CODE	X	Y
<b>B9141</b>	160mm	160mm

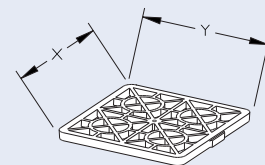



**HINGED - ALLOY SQUARE**

CODE	X	Y
<b>B6666</b>	150mm	150mm

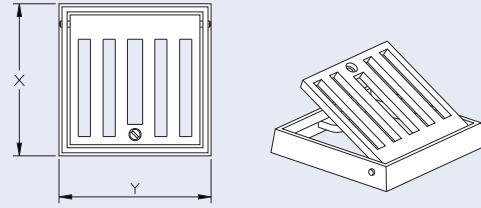

Approved by the NI Housing Executive

**ROUND ALLOY**

CODE	DIAMETER (d)
<b>B9151</b>	200mm

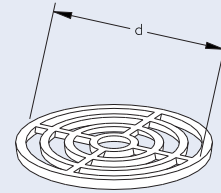

**ROUND PLASTIC**

CODE	DIAMETER (d)
<b>B9171</b>	200mm

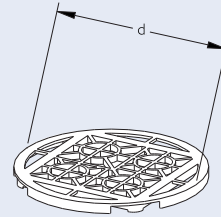

**SEALING PLATE - SQUARE DIE CAST ALLOY**

CODE	X	Y
<b>B9201</b>	160mm	160mm

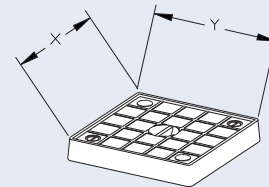

**SEALING PLATE - ROUND DIE CAST ALLOY**

CODE	DIAMETER (d)
<b>B9221</b>	200mm

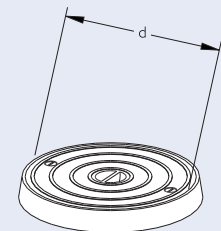

**Additional items available on request**

**Bars For Integral Hopper Code B1034**

**Plate For Integral Hopper Code B1035**

**280mm dia CHAMBER BASE**

**205mm INVERT (inc. 2 SOCKET PLUGS)**

CODE	SIZE	DIAMETER (d)	Y
<b>B2800</b>	110mm	280mm	392mm

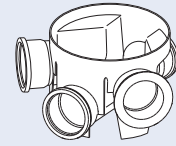
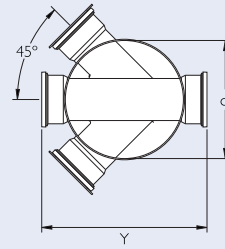

**280mm dia 90° CHAMBER BASE (205mm INVERT)**

CODE	SIZE	DIAMETER (d)	Y
<b>B2803</b>	110mm	280mm	305mm

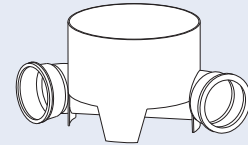
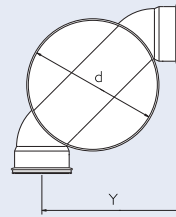

**280mm dia SHALLOW ACCESS CHAMBER 185mm RISER**

CODE	SIZE	DIAMETER (d)	INVERT (i)
<b>B2801</b>	110mm	266mm	185mm

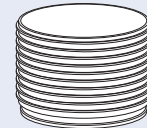
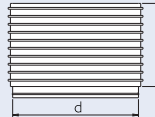

**280mm dia SHALLOW ACCESS CHAMBER SQUARE DOUBLE SEAL LID (Black PVCu)**

**(For Pedestrian Areas Only)**

CODE	SIZE	DIAMETER (d)
<b>B2802</b>	110mm	266mm

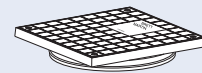
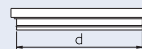

At installation, we recommend that a copper impregnated grease should be applied to the threads of the lid retaining screws for ease of removal.

**315mm SHALLOW ACCESS CHAMBER BASE (inc 2 socket plugs) EN 13598-1** ♡

CODE	SIZE	DIAMETER (d)	INVERT (i)
<b>B3156</b>	110mm	315mm	190mm

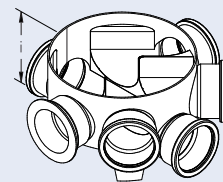
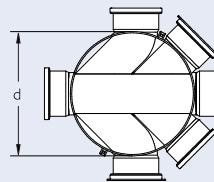

**315mm SHALLOW ACCESS CHAMBER RISER EN 13598-1** ♡

CODE	DIAMETER (d)	INVERT (i)
<b>B3157</b>	315mm	185mm

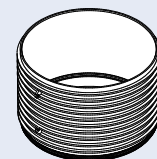
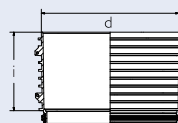

**315mm SHALLOW ACCESS CHAMBER SEAL EN 13598-1 (replacement seal for B3157)**

CODE	DIAMETER (d)
<b>B3158</b>	315mm

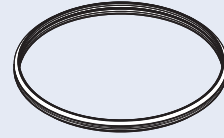

**315mm dia. SHALLOW ACCESS CHAMBER BASE 190mm INVERT (inc. 2 Socket Plugs)**

CODE	SIZE	DIAMETER (d)	INVERT (i)
<b>B3150</b>	110mm	315mm	190mm

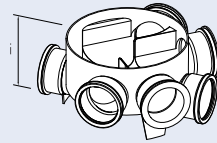
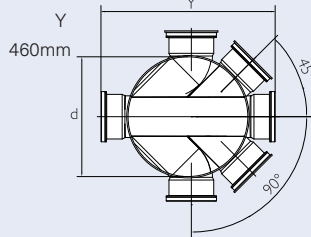

**315mm dia SHALLOW ACCESS CHAMBER RISER 185mm INVERT**

CODE	SIZE	DIAMETER (d)	INVERT (i)
<b>B3151</b>	110mm	315mm	185mm

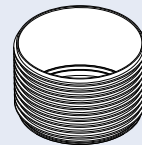
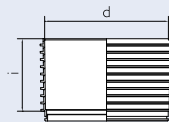

**315mm dia. SHALLOW ACCESS CHAMBER SEALED LID (PEDESTRIAN) Black PVCu**

CODE	SIZE	DIAMETER (d)	Y
<b>B3153</b>	110mm	315mm	330mm

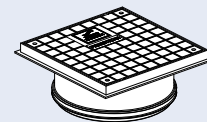
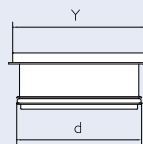

**315mm dia. SHALLOW ACCESS CHAMBER SEALED LID (DRIVEWAY 35kN) Black PVCu**

CODE	SIZE	DIAMETER (d)	Y
<b>B3154</b>	110mm	315mm	330mm

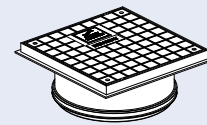
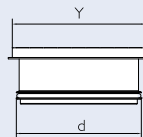

**450mm x 110mm INSPECTION CHAMBER BASE (inc 3 socket plugs) EN 13598-1** ♡

CODE	SIZE	DIAMETER (d)	INVERT (i)
<b>B4500</b>	110mm	450mm	225mm

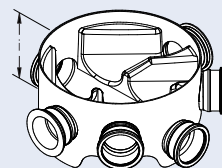
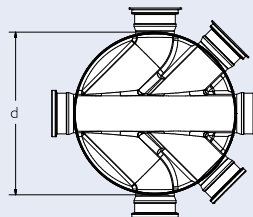

**450mm x 160mm INSPECTION CHAMBER BASE (inc 3 socket plugs) EN 13598-1**

CODE	SIZE	INVERT (i)
<b>B4506</b>	160mm	255mm

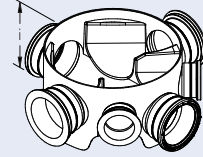
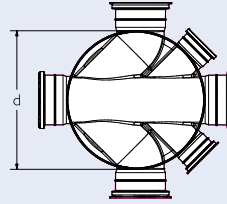

**450mm INSPECTION CHAMBER RISER EN 13598-1**



CODE	DIAMETER (d)	INVERT (i)
<b>B4502</b>	450mm	300mm

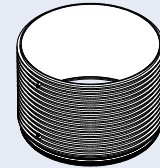
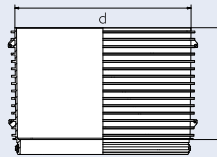

**450mm INSPECTION CHAMBER SEAL to EN 13598-1 (replacement seal for B4502)**

CODE	DIAMETER (d)
<b>B4503</b>	450mm

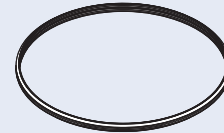

**450mm dia INSPECTION CHAMBER BASE (inc. 3 Socket Plugs)**

CODE	SIZE	INVERT (i)	DIAMETER (d)
<b>B5494</b>	110mm	225mm	450mm

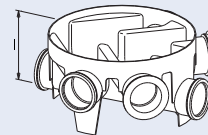
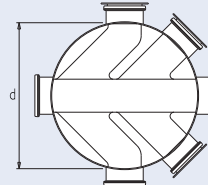

**450mm dia INSPECTION CHAMBER BASE (inc. 3 Socket Plugs)**

CODE	SIZE	INVERT (i)	DIAMETER (d)
<b>B5696</b>	160mm	255mm	450mm

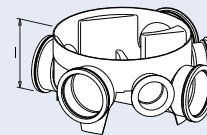
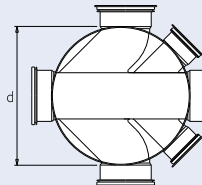

**450mm dia CHAMBER RISER**

CODE	INVERT (i)	DIAMETER (d)
<b>B5397</b>	315mm	450mm

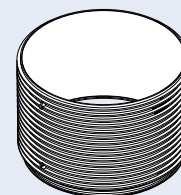
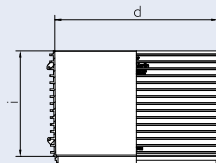

**450mm SEALING RING – FOR USE WITH CODE B5397**

(optional for where sealed chamber sections are required)

CODE	DIAMETER (d)
<b>B5398</b>	450mm

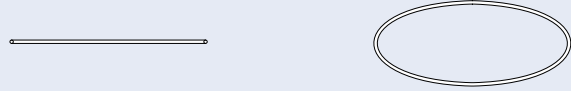

**SECURED PLASTIC COVER AND FRAME TO EN124 A15 50KN**

(suitable for domestic driveways)

CODE	Y	DIAMETER (d)
<b>B6255</b>	518mm	450mm

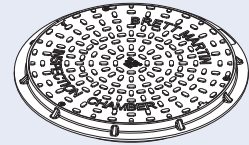
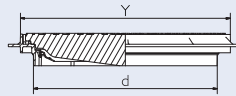

**SECURED SQUARE PLASTIC COVER AND FRAME TO EN124 A15 50KN**

(suitable for domestic driveways)

CODE	Y	DIAMETER (d)
<b>B6260</b>	545mm	450mm

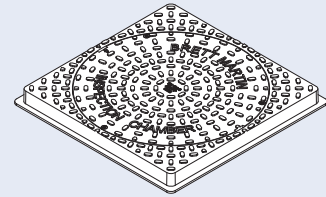
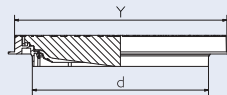

**450mm X 350mm REDUCER - USE WHEN CHAMBER INVERT IS BETWEEN 1 - 2 AND 3mtrs**

CODE	SIZE
<b>B6350</b>	450mm X 350mm

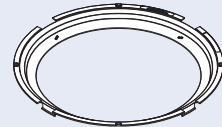

**SPARE SOCKET PLUG**

CODE	SIZE
<b>B5000</b>	110mm
<b>B5100</b>	160mm

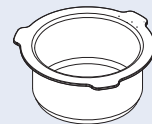

Long Radius Channel Bends in GB are sold without the lip.

**CHANNEL PIPE PLAIN ENDED**

CODE	SIZE	Y	LENGTH
<b>B2281</b>	110mm	600mm	1.5m
<b>B2291</b>	110mm	900mm	2.0m
<b>B3001</b>	160mm	600mm	1.5m
<b>B3011</b>	160mm	900mm	2.0m

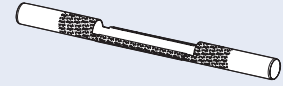
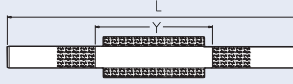

**CHANNEL PIPE PLAIN ENDED - "LIPPED & CHIPPED"**

(DOE (NI) Approved Cert. No P/OL/WSC 5.3.91)

CODE	SIZE	Y	LENGTH
<b>B20123</b>	200mm	600mm	1.5m
<b>B25123</b>	250mm	900mm	2.0m
<b>B31123</b>	315mm	600mm	1.5m
<b>B40123</b>	400mm	900mm	2.0m

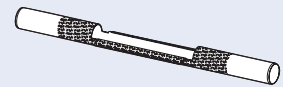
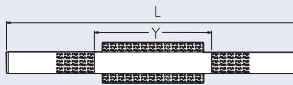

**CHANNEL CONNECTOR**

CODE	SIZE	X	Y
<b>B2301</b>	110mm	600mm	300mm
<b>B3021</b>	160mm	600mm	300mm

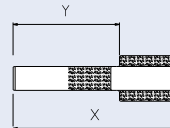

**CHANNEL TAPER**

CODE	SIZE	X
<b>B3351</b>	160mm X 110mm	180mm

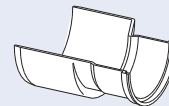
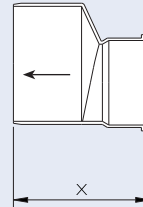

**87<sup>1</sup>/<sub>2</sub>° LONG RADIUS PLAIN END CHANNEL BEND**

CODE	SIZE	RADIUS
<b>B2531</b>	110mm	450mm
<b>B3331</b>	160mm	940mm

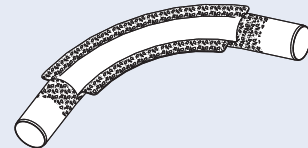
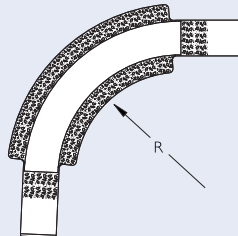

**87<sup>1</sup>/<sub>2</sub>° PLAIN END CHANNEL BEND "LIPPED & CHIPPED"**

(DOE (NI) Approved Cert. No P/OL/WSC 5.3.91)

CODE	SIZE	RADIUS
<b>B20901</b>	200mm	940mm
<b>B25901</b>	250mm	940mm
<b>B31901</b>	315mm	940mm
<b>B40901</b>	400mm	940mm

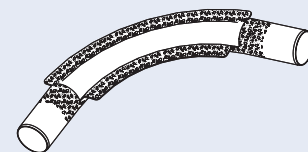
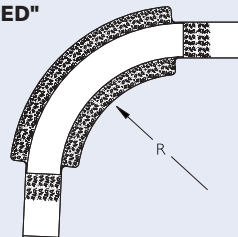

Long Radius Channel Bends in GB are sold without the lip.

**45° LONG RADIUS PLAIN END CHANNEL BEND**

CODE	SIZE	RADIUS
<b>B2532</b>	110mm	450mm
<b>B3332</b>	160mm	940mm

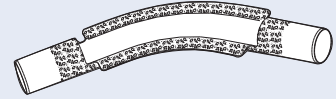
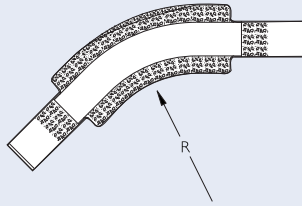

**45° PLAIN END CHANNEL BEND "LIPPED & CHIPPED"**

(DOE (NI) Approved Cert. No P/OL/WSC 5.3.91)

CODE	SIZE	RADIUS
<b>B20451</b>	200mm	940mm
<b>B25451</b>	250mm	940mm
<b>B31451</b>	315mm	940mm
<b>B40451</b>	400mm	940mm

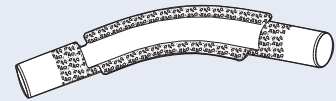
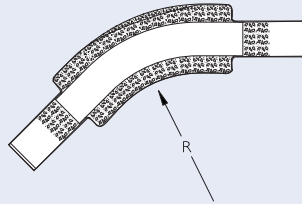

**30° PLAIN END CHANNEL BEND "LIPPED & CHIPPED"**

(DOE (NI) Approved Cert. No P/OL/WSC 5.3.91)

CODE	SIZE	RADIUS
<b>B20301</b>	200mm	940mm
<b>B25301</b>	250mm	940mm
<b>B31301</b>	315mm	940mm
<b>B40301</b>	400mm	940mm

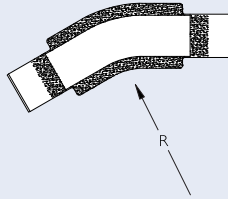

**15° PLAIN END CHANNEL BEND "LIPPED & CHIPPED"**

(DOE (NI) Approved Cert. No P/OL/WSC 5.3.91)

CODE	SIZE	RADIUS
<b>B20151</b>	200mm	940mm
<b>B25151</b>	250mm	940mm
<b>B31151</b>	315mm	940mm
<b>B40151</b>	400mm	940mm

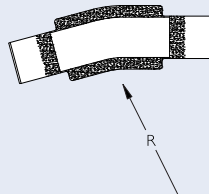

**22 1/2° LONG RADIUS PLAIN END CHANNEL BEND**

CODE	SIZE	RADIUS
<b>B2533</b>	110mm	450mm
<b>B3333</b>	160mm	940mm

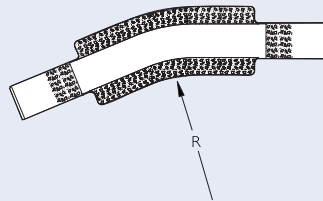

**11 1/4° LONG RADIUS PLAIN END CHANNEL BEND**

CODE	SIZE	RADIUS
<b>B2534</b>	110mm	450mm
<b>B3334</b>	160mm	940mm

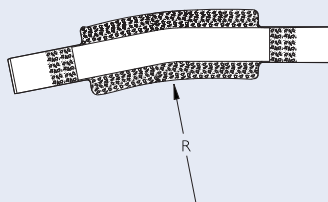

Long Radius Channel Bends in GB are sold without the lip.

**3/4 SECTION BRANCH BEND 30° LEFT HAND**

CODE	SIZE
<b>B2221</b>	110mm
<b>B3371</b>	160mm

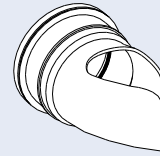
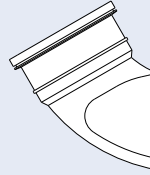

**3/4 SECTION BRANCH BEND 30° RIGHT HAND**

CODE	SIZE
<b>B2621</b>	110mm
<b>B3372</b>	160mm

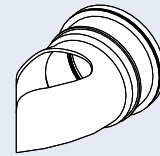
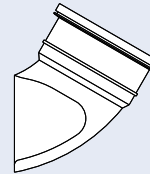

**3/4 SECTION BRANCH BEND 90° LEFT HAND**

CODE	SIZE
<b>B2251</b>	110mm
<b>B3401</b>	160mm

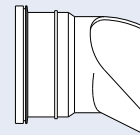
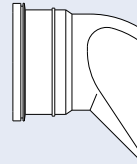

**3/4 SECTION BRANCH BEND 90° RIGHT HAND**

CODE	SIZE
<b>B2651</b>	110mm
<b>B3402</b>	160mm

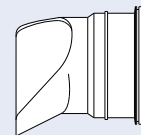
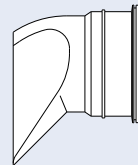

Other 3/4 section branches and bends are available to order.



**ROAD GULLIES WITH INTEGRAL TRAP**

CODE	SIZE	INVERT	DIAMETER
<b>B9450</b>	160mm	900mm	450mm
<b>B7450</b>	160mm	750mm	450mm

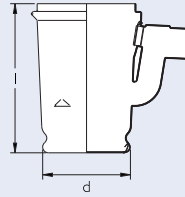

**87<sup>1</sup>/<sub>2</sub>° ACCESS BEND**

CODE	SIZE
<b>B1839</b>	110mm

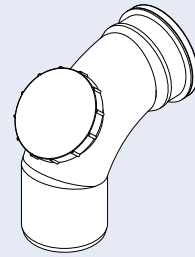
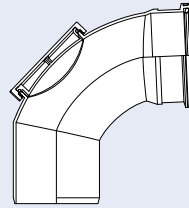

**SINGLE SOCKET ACCESS PIPE**

CODE	SIZE	Y
<b>B5104</b>	110mm	240mm
<b>B7104</b>	160mm	355mm

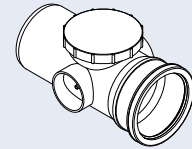
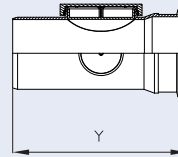

**ALUMINIUM RODDING POINT SOCKETED AND SEALED**

CODE	SIZE	X	Y	Z
<b>B5592</b>	110mm	114mm	47mm	188mm
<b>B6691</b>	160mm	138mm	64mm	254mm

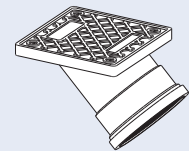
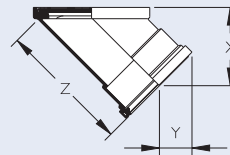

**ALUMINIUM RODDING POINT - OVAL**

CODE	SIZE	X	Y	Z
<b>B5591</b>	110mm	89mm	39mm	166mm

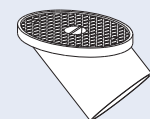
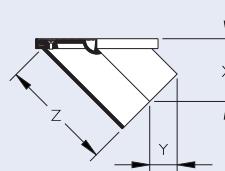

**SCREW ACCESS COVER** 

CODE	SIZE	X
<b>B5091</b>	110mm	80mm
<b>B7071*</b>	160mm	130mm

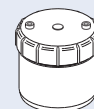
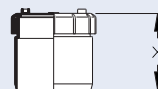

The following Access Pipe Screw on Covers are available on request: **B20122** 200mm, **B25122** 250mm, **B31122** 315mm, **B40122** 400mm

\*Not kitemarked

**TWINWALL PIPE**

CODE	(SOLID)CODE (PERF)	SIZE	LENGTH
<b>1TP6</b>	1TPP6	150mm	6m
<b>2TP6</b>	2TPP6	225mm	6m
<b>3TP6</b>	3TPP6	300mm	6m
<b>37TP6</b>	37TPP6	375mm	6m
<b>45TP6</b>	45TPP6	450mm	6m
<b>60TP6</b>	60TPP6	600mm	6m

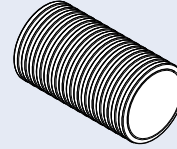

Half Perforated Pipe options are available to special order for 150mm, 225mm and 300mm diameters.

**COUPLERS**

CODE	SIZE
<b>1TC</b>	150mm
<b>2TC</b>	225mm
<b>3TC</b>	300mm
<b>37TC</b>	375mm
<b>45TC</b>	450mm
<b>60TC</b>	600mm

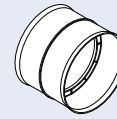

**SEALING RING**

CODE	SIZE
<b>1TSR</b>	150mm
<b>2TSR</b>	225mm
<b>3TSR</b>	300mm
<b>37TSR</b>	375mm
<b>45TSR</b>	450mm
<b>60TSR</b>	600mm

**DOUBLE SOCKET BEND**

CODE	A (suitable pipe size)	B	C	D	E
<b>1TB15</b>	150mm NB Twinwall Pipe	15°	303mm	272mm	90mm
<b>1TB30</b>	150mm NB Twinwall Pipe	30°	377mm	309mm	90mm
<b>1TB45</b>	150mm NB Twinwall Pipe	45°	403mm	334mm	90mm
<b>1TB90</b>	150mm NB Twinwall Pipe	90°	378mm	378mm	90mm
<b>2TB15</b>	225mm NB Twinwall Pipe	15°	400mm	380mm	125mm
<b>2TB30</b>	225mm NB Twinwall Pipe	30°	479mm	422mm	125mm
<b>2TB45</b>	225mm NB Twinwall Pipe	45°	537mm	462mm	125mm
<b>2TB90</b>	225mm NB Twinwall Pipe	90°	521mm	521mm	125mm
<b>3TB15</b>	300mm NB Twinwall Pipe	15°	461mm	472mm	140mm
<b>3TB30</b>	300mm NB Twinwall Pipe	30°	568mm	521mm	140mm
<b>3TB45</b>	300mm NB Twinwall Pipe	45°	648mm	570mm	140mm
<b>3TB90</b>	300mm NB Twinwall Pipe	90°	630mm	630mm	140mm

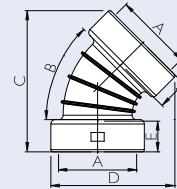

**TRIPLE SOCKET BRANCHES - 45°**

CODE	A (Suitable Pipe Size)	B (Suitable Pipe Size)	C	D	E	F
<b>1TY45</b>	150mm NB Twinwall Pipe	150mm NB Twinwall Pipe	486mm	90mm	90mm	448mm
<b>2TY45</b>	225mm NB Twinwall Pipe	225mm NB Twinwall Pipe	712mm	125mm	125mm	640mm
<b>2TY145</b>	225mm NB Twinwall Pipe	150mm NB Twinwall Pipe	662mm	125mm	90mm	552mm
<b>3TY45</b>	300mm NB Twinwall Pipe	300mm NB Twinwall Pipe	825mm	140mm	140mm	727mm
<b>3TY245</b>	300mm NB Twinwall Pipe	225mm NB Twinwall Pipe	865mm	140mm	125mm	790mm
<b>3TY145</b>	300mm NB Twinwall Pipe	150mm NB Twinwall Pipe	694mm	140mm	90mm	649mm

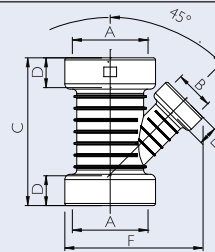

**TRIPLE SOCKET BRANCHES - 90°**

CODE	A	B	C	D	E	F
<b>1TT90</b>	150mm NB Twinwall Pipe	150mm NB Twinwall Pipe	461mm	90mm	90mm	338mm
<b>2TT90</b>	225mm NB Twinwall Pipe	225mm NB Twinwall Pipe	662mm	125mm	125mm	501mm
<b>2TT190</b>	225mm NB Twinwall Pipe	150mm NB Twinwall Pipe	587mm	125mm	90mm	448mm
<b>3TT90</b>	300mm NB Twinwall Pipe	300mm NB Twinwall Pipe	777mm	140mm	140mm	602mm
<b>3TT290</b>	300mm NB Twinwall Pipe	225mm NB Twinwall Pipe	674mm	140mm	125mm	572mm
<b>3TT190</b>	300mm NB Twinwall Pipe	150mm NB Twinwall Pipe	614mm	140mm	90mm	537mm

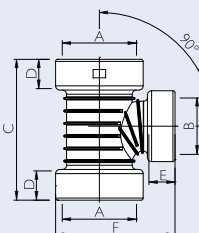

Note: Other fittings are available up to 600mm dia. to special order

**6m BLOWN SOCKET DUCT PIPE**

CODE	SIZE	Y	LENGTH	WT
<b>BD2</b>	53.9mm	55mm	6m	1.6mm
<b>BD3</b>	89mm	75mm	6m	1.8mm
<b>BD4</b>	110mm	100mm	6m	2.2mm
<b>BD6</b>	160mm	125mm	6m	3.3mm
<b>BD8</b>	200mm	125mm	6m	3.3mm

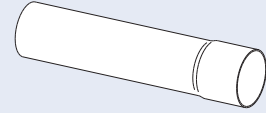
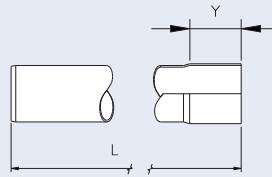

**DUCT COUPLER**

CODE	SIZE	Y
<b>BD2C</b>	53.9mm	170mm
<b>BD3C</b>	89mm	185mm
<b>BD4C</b>	110mm	250mm
<b>BD6C</b>	160mm	345mm
<b>BD8C</b>	200mm	475mm

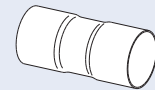
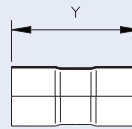

**87<sup>1</sup>/<sub>2</sub>° LONG RADIUS BLOWN SOCKET DUCT BEND**

CODE	SIZE	R
<b>BD2B</b>	53.9mm	300mm
<b>BD3B</b>	89mm	300mm
<b>BD4B</b>	110mm	450mm
<b>BD6B</b>	160mm	940mm

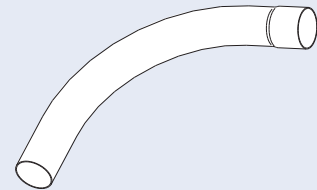
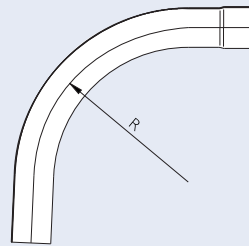

**45° LONG RADIUS BLOWN SOCKET DUCT BEND**

CODE	SIZE	R
<b>BD2BA</b>	53.9mm	350mm
<b>BD3BA</b>	89mm	350mm
<b>BD4BA</b>	110mm	450mm
<b>BD6BA</b>	160mm	940mm

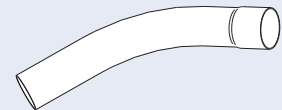
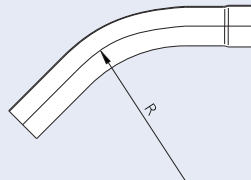

**6m BLOWN SOCKET DUCT PIPE TO BS 4660 / BS 5481**

CODE	SIZE	Y	LENGTH	WT
<b>B4011D</b>	110mm	100mm	6m	3.2mm
<b>B6011D</b>	160mm	125mm	6m	4.1mm
<b>B8011D</b>	200mm	125mm	6m	4.9mm

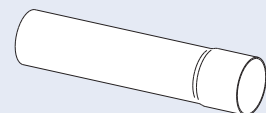
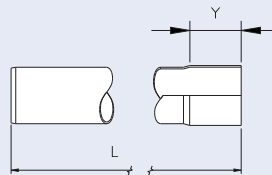

**STORMCRATE55 (Incl 2 shear pins and 4 connectors)**

CODE	X	Y	Z
<b>B8250</b>	1200mm	600mm	347mm

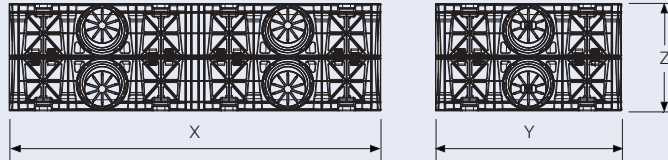

**SPARE RUBBER RING FITTINGS**

CODE	SIZE
<b>B9161</b>	110mm
<b>B9121</b>	160mm

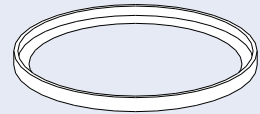

**RING SEAL (PIPE)**

CODE	SIZE
<b>S/S110</b>	110mm
<b>S/S160</b>	160mm
<b>B20000</b>	200mm
<b>B25000</b>	250mm
<b>B31000</b>	315mm
<b>B40000</b>	400mm

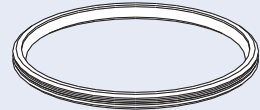

**SOLVENT CLEANER**

CODE	SIZE
<b>B9031</b>	250ml
<b>B9032</b>	500ml

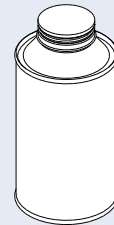

**SOLVENT CEMENT**

CODE	SIZE
<b>B9020</b>	125ml
<b>B9021</b>	250ml
<b>B9022</b>	500ml
<b>B9023</b>	250ml - Heavy Duty

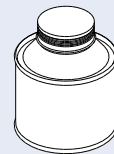

**PIPE LUBRICANT**

CODE	SIZE
<b>B5399</b>	78ml
<b>B9333</b>	0.5kg Tub (Gel)
<b>B9444</b>	5kg Tub (Gel)
<b>B9555</b>	400ml (Spray)

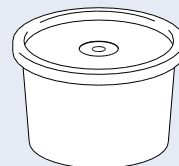
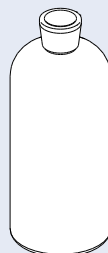

**TECHNICAL INFORMATION**

FUNCTION	<b>38</b>
AUTHORITY	<b>38</b>
STANDARDS	<b>38</b>
COMPOSITION	<b>38</b>
BIOLOGICAL AND CHEMICAL RESISTANCE	<b>38</b>
GENERAL RESISTANCES	<b>38</b>

**GENERAL INFORMATION**

STORAGE	<b>39</b>
HANDLING	<b>39</b>
TRANSPORT	<b>39</b>

**INSTALLATION**

	Page
INSTALLATION – GENERAL POINTS	<b>40</b>
FLOW PROPERTIES	<b>40</b>
CHOICE OF GRADIENTS	<b>41</b>
PIPE SIZING	<b>41</b>
FLOW PROPERTIES – CLEAN SEWERS	<b>42</b>
FLOW PROPERTIES – MATURE SEWERS	<b>43</b>
FLOW PROPERTIES – ROUGH BORE	<b>44</b>
SPECIAL PROTECTION – GROUND LOADS	<b>45</b>
TRENCH PREPARATION	<b>45</b>
MATERIALS FOR BEDDING	<b>46</b>
EASE OF COMPACTION	<b>47</b>
PIPE LAYING	<b>47</b>
SPECIAL PROTECTION – SETTLEMENT	<b>48</b>
SPECIAL PROTECTION – SURCHARGING	<b>48</b>
ACCESS TO DRAINS	<b>49</b>
PREFORMED INSPECTION CHAMBERS	<b>50-51</b>
SHALLOW ACCESS CHAMBERS	<b>52</b>
ACCESS AND INSPECTION CHAMBERS	<b>53</b>
OPEN CHANNEL MANHOLES	<b>54</b>
BACKDROP MANHOLE CONSTRUCTION	<b>55</b>
RODDING ACCESS	<b>56</b>
HEAD OF DRAIN RODDING POINT	<b>56</b>
UNIVERSAL RODDABLE BOTTLE GULLY	<b>57</b>
RODDING ACCESS	<b>57</b>
TYPICAL LAYOUT USING RODDING	
ACCESS COMPONENTS	<b>57</b>
TYPICAL INSTALLATION (ENGLAND & WALES)	<b>58</b>
TRADITIONAL GULLY ASSEMBLY	<b>58</b>
HORIZONTAL BACK INLET ASSEMBLY	<b>59</b>
BOTTLE GULLY ASSEMBLY	<b>59</b>
SOIL PIPE CONNECTION (SHORT RADIUS)	<b>59</b>
SOIL PIPE CONNECTION (LONG RADIUS)	<b>60</b>
RAINWATER PIPE CONNECTIONS	<b>60</b>
SADDLE BRANCH, BRANCH ENTRIES	<b>60</b>
PIPE JOINTS	<b>61</b>
CUTTING	<b>61</b>
PUSH-FIT JOINTING	<b>61</b>
PERFORATED PIPE	<b>62</b>
SOLVENT CEMENT JOINTING	<b>63</b>
CONNECTION TO UNDERGROUND DRAINAGE	<b>64</b>
MAINTENANCE	<b>64</b>
CHEMICAL RESISTANCES	<b>65-67</b>

# TECHNICAL

**FUNCTION**

Brett Martin Underground Drainage offers a comprehensive range of drainage systems. It includes the Drain, Sewer, Perforated, Surface Water and Cable Duct systems. The entire range incorporates pipes and fittings in eight diameters from 53.9mm to 400mm.

Brett Martin Drain and Sewer Systems are complemented by the Brett Martin Surface Water and Soil and Waste systems providing a complete solution for all your drainage requirements.

**AUTHORITY**

Brett Martin Drainage systems satisfy the requirements of the following:-

- The Building Regulations 2010, Approved Document H
- Building (Scotland) Regulations 2004, Technical Handbook (Domestic & Non-Domestic) Section 3: Environment
- Building Regulations (Northern Ireland) 2012, Technical Booklet N
- Building Regulations 2010, Technical Guidance Document H (ROI)

**STANDARDS**

Brett Martin Drainage systems are manufactured under the following British and European Standards:-

- BS EN ISO 9001:2015 Quality Management Systems
- BS EN 1401-1:2009 Plastic piping systems for non-pressure underground drainage and sewerage (SN4). Unplasticized poly(vinyl chloride) (PVC-U). Part 1: Specifications for pipes, fittings and the system.
- BS EN 13598-1:2010 Plastics piping systems for non-pressure underground drainage and sewerage. Unplasticized poly(vinyl chloride) (PVC-U), polypropylene (PP) and polyethylene (PE). Part 1: Specifications for ancillary fittings including shallow inspection chambers.

**COMPOSITION**

Extruded pipe sections and injection moulded fittings are made from PVCu and polypropylene compounds complying with the material requirements of the relevant British Standards. They contain the necessary processing additives, stabilisers and pigments to give products excellent appearance, durability and performance.

**BIOLOGICAL AND CHEMICAL RESISTANCE**

Polluted industrial atmospheres will not effect Brett Martin drainage systems. PVC is vermin and rot proof and resistant to most commonly occurring chemicals: notable exceptions however are solvents, including those incorporated in most timber preservatives.

**GENERAL RESISTANCES**

Expected action

G - Good/Excellent resistance to attack

P - Poor resistance to attack

SUBSTANCE	EXPECTED ACTION
Mineral Acids (Diluted)	G
Mineral Acids (Concentrated)	G
Alkalis	G
Alcohol's	G
Ketones	P
Aromatic Hydrocarbons	P
Chlorinated Hydrocarbons	P
Greases and Oils	G

**STORAGE**

The following recommendations relate to the storage of PVCu pipes under the normal climatic conditions of the United Kingdom.

- a) Pipes should be stacked on a reasonably flat surface free from sharp projections, stones and other protuberances. Side supports should be provided at intervals of not more than 1.5m and these supports should preferably consist of battens not less than 75mm wide. However, if pipes are delivered in factory strapped bundles, no side supports are necessary.
- b) Pipes should be uniformly supported throughout their length, if this is not possible timber battens at least 75mm wide at spacings not greater than 1m centres should be placed beneath the pipes. Preferably pipes of different sizes and wall thicknesses should be stacked separately. Where this is not possible the pipes with larger diameters and thicker walls should be at the bottom. It is preferable that pipes should not be stacked one inside the other.
- c) If spigot and socket pipes are stacked, sockets should be placed at alternate ends of the stack with sockets protruding so that the pipes are evenly supported along their entire length. Pipe stacks should not exceed 7 layers with a maximum height of 2m.

**HANDLING**

Pipes made from PVCu are strong, though lightweight and are therefore very easily handled. However, it is necessary to take care to prevent damage; in particular, pipes should not be thrown, dropped or dragged along. If pipes are moved by rolling it is necessary to support them along their length and properly restrain them on inclines.

If pipes are loaded or unloaded by mechanical means (forklift, crane etc,) care should be taken to prevent damage. Pipes should be properly supported in two places when lifted. Preferably protected slings should be used, if metal chains and hooks are all that is available, padding should be placed between them and the pipes. If pipes are delivered stuffed, special care should be taken to avoid damage during unloading.

**IMPORTANT**

The impact strength of PVCu is reduced in cold weather during which time extra care must be taken to prevent site damage.

**TRANSPORT**

Vehicles with a flat bed should be used for the transport of pipes. The bed should be free from nails or other projections. Each pipe should be supported uniformly along its length. Vehicles should have adequate side supports at not more than 1.5m centres and pipes should be well secured during transit. All uprights should be flat and free from sharp edges.

When loading spigot/socket pipes, they should be stacked in alternate layers so that the sockets do not carry any load.

Pipes should be loaded onto vehicles in such a way that any overhang does not exceed 1m. Thick walled pipes must be loaded before thin walled pipes.

**GENERAL**

The ability of a rigid pipe to support the total load transmitted to it is established by reference to actual crushing tests to cause fracture. Flexible pipes such as those made from unplasticized PVC do not fracture under load but they are liable to deformation. The extent of this deformation depends largely upon the compaction of the immediate surrounding fill. For this reason, flexible pipes should always be surrounded with non-cohesive material. This surround should extend to the trench width in normal trench situations. The external loads (backfill and surcharge) imposed on a pipe of rigid material (such as vitrified clay, concrete, asbestos cement or cast iron) are supported mainly (sometimes wholly) by the resistance of the pipe to circumferential bending. On the other hand unplasticized PVC pipes, being relatively flexible, offer less resistance to circumferential deformation and rely partly on external support to resist deformation. Therefore, it is of primary importance for unplasticized PVC pipes that fill material, particularly the bedding and sidefill, should be properly compacted in order to prevent excessive deformation.

It is desirable that vertical deformation should be limited to 5% on completion of the backfilling, which can only be achieved by proper compaction of the backfill (Please refer to Codes of Practice BS 5955 and BS EN 752).

It is essential to avoid high stress concentrations and sharp objects such as large stones or flints which should not be allowed to come into contact with the surface of the pipe.

The flexible nature of unplasticized PVC pipes helps them to accommodate deformations resulting from ground movement or from other differential settlement under normal circumstances.

Except in special circumstances, e.g. at very shallow cover depths or where it is necessary to safeguard the foundations of existing structures, the use of concrete for bedding or surrounding the pipes is unnecessary. Figure 4 (in "Special Protection - Ground Loads" section) illustrates the use of concrete in special local circumstances.

Normally drainage pipework is laid in straight lines. However, in special circumstances and subject to approval it may sometimes be acceptable to "spring" the jointed pipes to a slight curve to avoid an obstacle, or to follow the curvature of a street. If this is done, and the joints are of the push-in type, care has to be taken not to spring the pipework to, too sharp a curve or the joints may be overstrained and fail later. The manufacturer should be consulted as to the minimum radius that can be accommodated in this way. Straining of the joints can be minimised by firmly backfilling a short length of pipe. The pipe should be anchored in this position by further backfilling before the next joint is made, and the process repeated as necessary. The trench may need to be widened on the curve to accommodate the pipe in its straight position. It is essential that the jointing is always carried out in the straight position.

**FLOW PROPERTIES**

The following is based upon information given in the code of practice BS 5955: Part 6: 1980.

For the purposes of calculating flow rates through PVCu pipes, reference should be made to the Colebrook-White equation. Figures have been derived using values for roughness ( $k_s$ ) given in the "Hydraulic Research Station Charts", 4th edition (metric), 1978 and "Tables for the hydraulic design of pipes" (metric edition), 1977 for the sizes of PVCu pipes dealt with in this code. It is recommended that the information given in Figure 3(b) is used for velocities less than 1 m/s.

These values of roughness are for guidance only and may need future modification in the light of continuing research work.



## CHOICE OF GRADIENTS

Choice of gradients should be such as to maintain self-cleansing velocity under normal discharge conditions.

To achieve a satisfactory installation, diameter and gradient should be adequate for the maximum flow and competent supervision should be provided to ensure a high standard of pipe quality, laying, jointing and workmanship. This is particularly important when pipes are laid to flat gradients.

The following guidelines on gradients should be observed:

- a) For flows of less than 1 L/s, pipes not exceeding 100mm nominal bore at gradients not flatter than 1:40 have proved satisfactory.
- b) Where the peak flow is more than 1 L/s, a 100mm nominal bore pipe may be laid at a gradient not flatter than 1:80, provided that at least one WC is connected.
- c) 150mm nominal bore pipe may be laid at a gradient not flatter than 1:150, provided that at least five WC's are connected.
- d) Experience has shown that for gradients flatter than those given in items a) and c), a high standard of design and workmanship is necessary if blockages are to be minimised. Where this has been achieved, gradients of 1:130 for 100mm nominal bore pipes and 1:200 for 150mm nominal bore pipes have been used successfully.

Where the available fall is less than that necessary to achieve the recommended gradient, increasing the pipe diameter particularly at low flows is not a satisfactory solution. It will lead to a reduction in velocity and depth of flow and an increase in the tendency for deposits to accumulate in the pipes.

Where it is expected that a drain may be affected by settlement, the selected gradient should be such as to ensure that a satisfactory fall will be maintained.

Research has shown that high velocities of sewage flow arising from steep gradients do not cause increased erosion of pipes or deposition of solids. In such situations drains should be laid at gradients, which are the most economical in excavation and cost. High velocities can, however, cause excessive turbulence at bends and manholes and lead to fouling. Where this occurs it can be mitigated for example by using long radius or sealed access fittings.

## PIPE SIZING

### PVCu PIPE SIZES COMPARED WITH TRADITIONAL PIPE SIZES

The diameters of Brett Martin PVCu pipes increase in approximately 50mm increments compared with the 75mm generally for other materials, this enables pipes to be matched to design requirements more accurately and economically.

FIGURE 1 COMPARISON OF PIPE SIZES

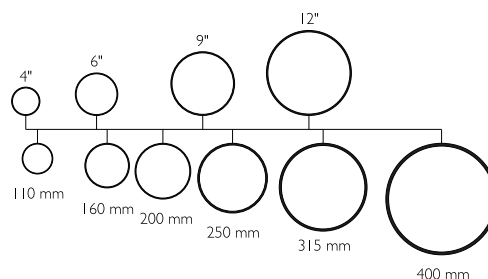

FLOW PROPERTIES

CLEAN SEWERS

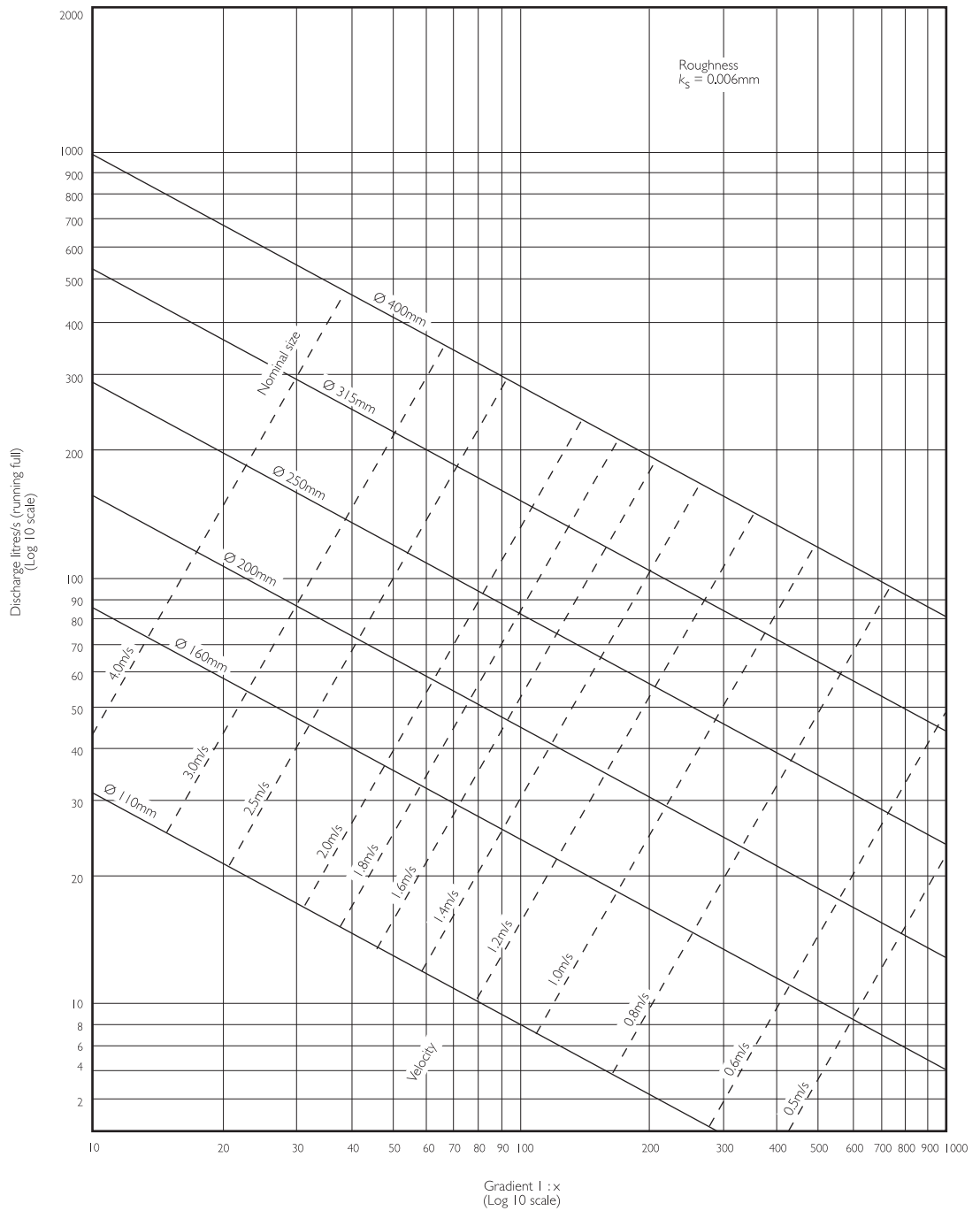

FIGURE 2  
Discharge rates of clean sewers made from PVCu pipes in the nominal size range 110mm to 400mm for different gradients based on a roughness,  $k_s$ , of 0.006mm.

FLOW PROPERTIES

MATURE SEWERS

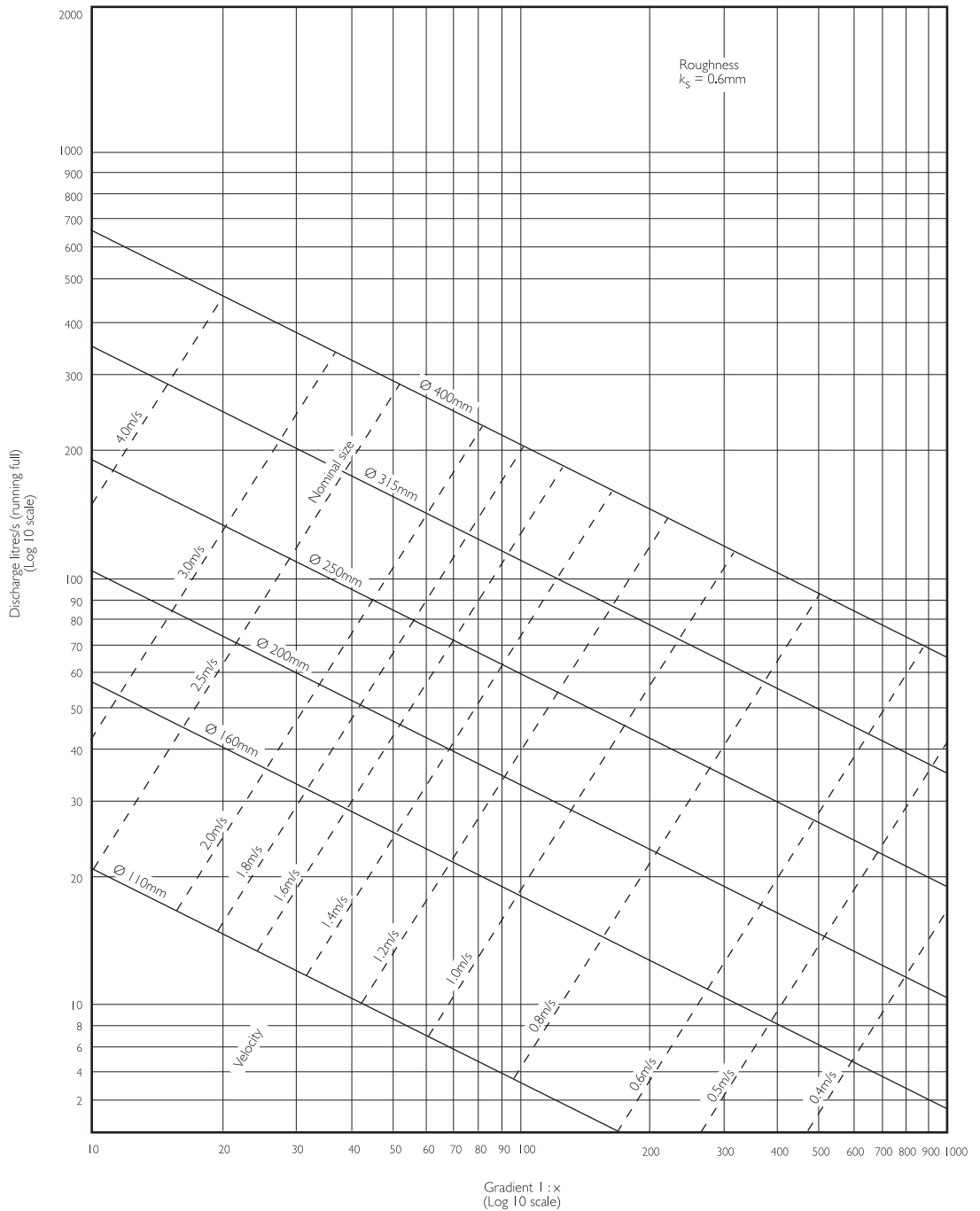

FIGURE 3

(a) Based on a roughness,  $k_s$ , of 0.6mm

Discharge rates of mature sewers made from PVCu pipes in the nominal size range from 110mm to 400mm for different gradients.

FLOW PROPERTIES

ROUGH BORE

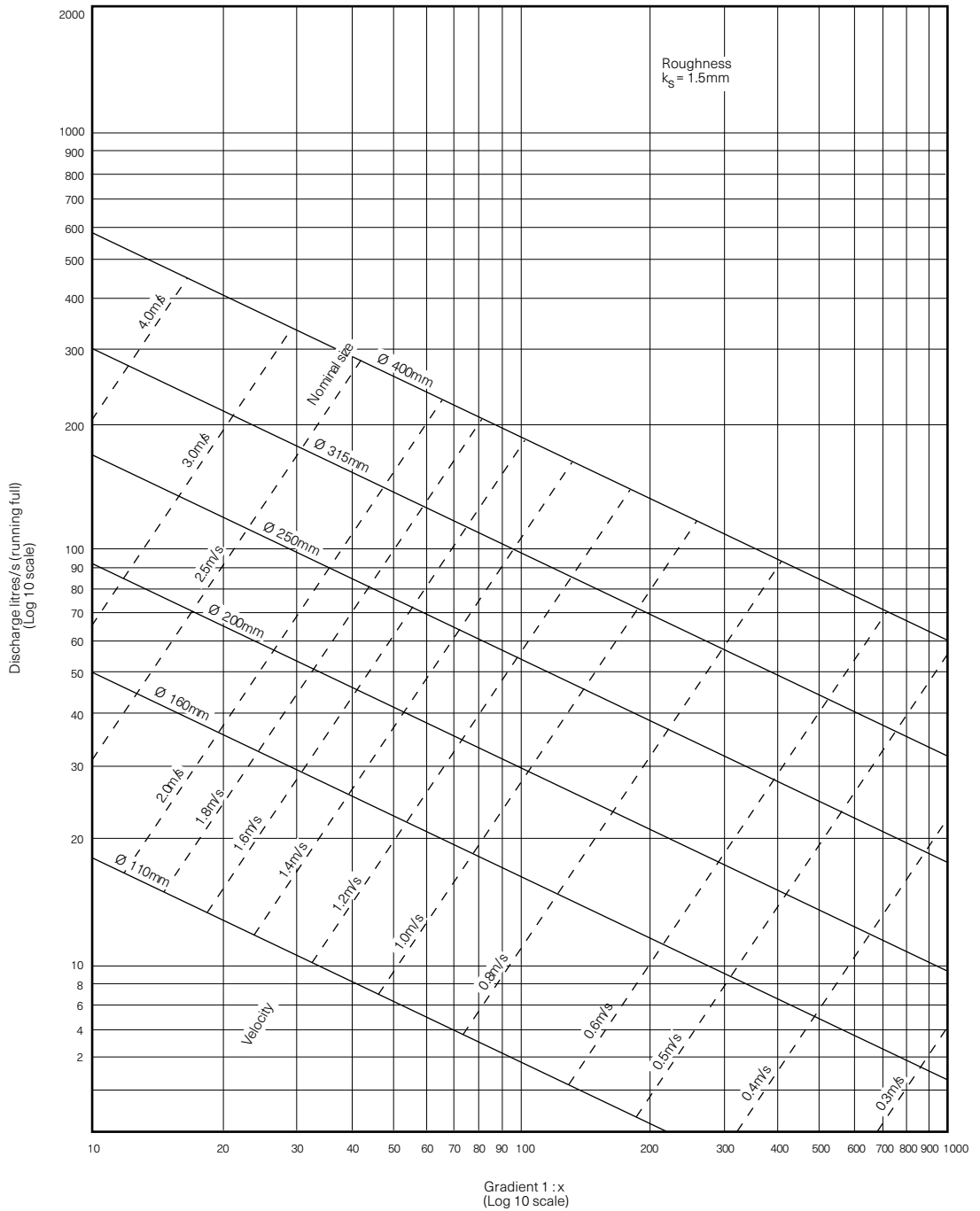

FIGURE 3 (CONCLUDED)  
(b) Based on a roughness,  $k_s$ , of 1.5mm

**SPECIAL PROTECTION -  
GROUND LOADS**

Where a rigid pipe of:-

- a) less than 150mm diameter has less than 300mm depth of cover, or
- b) 150mm or more diameter has less than 600mm depth of cover,

it should be surrounded with concrete either 100mm or the diameter of the pipe, whichever is greater, in thickness and have movement joints, at not more than 5m centres.

Where a flexible pipe has less than 300mm depth of cover under an area other than a vehicular area, it should have concrete paving slabs laid as bridging on granular or other flexible filling at least 75mm above the top of the pipe. Where a flexible pipe has less than 600mm depth of cover under a vehicular area it should have a reinforced concrete slab laid as bridging in a similar manner.

FIGURE 4

**PROTECTION FOR FLEXIBLE PIPES**

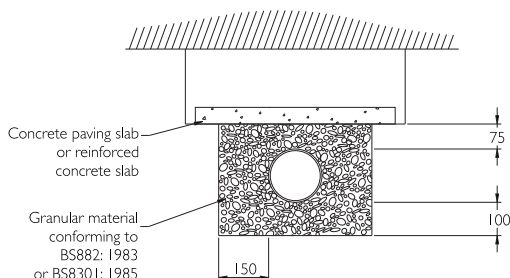

**TRENCH PREPARATION**

FIGURE 5

**BEDDING FOR FLEXIBLE PIPES**

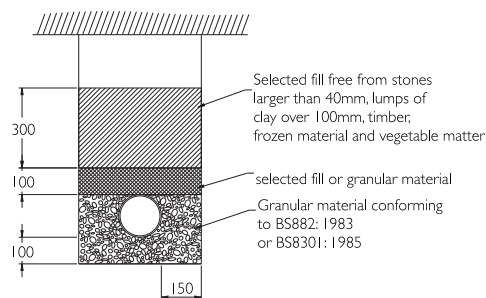

1. Provision shall be required to prevent ground water flow in open trenches.
2. The barrel of the pipe shall have continuous bearing on the floor of the trench or the granular fill.

The trench should not be opened too long in advance of pipe laying and should be backfilled as soon as possible. It is essential to ensure that the sides of the trenches are adequately supported in accordance with the requirements of BS6031. To minimise a possible hazard, a trench should be open for the minimum time practicable.

At the crown of the pipe and for 300mm, or one pipe diameter if greater, above it the width of the trench within any timbering should be as narrow as is practicable, but not less than the outside diameter of the pipe plus sufficient extra width (usually about 150mm) on each side of the pipe to provide access for making the joints and placing and compacting sidefill. Above this level, the trench may be of any convenient width.

If the "as-dug" material is suitable for use as bedding, the bottom of the trench may be trimmed to form the pipe bed. Otherwise, the trench should be excavated to an adequate depth below the invert level of the pipe to allow for the necessary thickness of bedding material. The thickness of bedding under the barrel of the pipes should be a minimum of 100mm, but in very wet or soft conditions or where the trench bottom is very irregular, it may be necessary to increase this thickness. Bedding should be properly compacted and finished so as to provide uniform support for the pipe. It is essential that bricks or other hard materials are not placed under the pipes for temporary or permanent support.

Material to be used for bedding and surrounding the pipes should be selected granular material, either available locally or, if necessary, brought to the site. Suitable materials are described in Table 1.

TABLE 1

**SUITABLE MATERIAL FOR BEDDING AND SURROUNDING PIPES**

Nominal pipe size (mm)	Material (complying with the requirements of BS882:Part 2)
110	10mm, nominal single-sized aggregate
160	10mm or 14mm, nominal single-sized aggregate or 14 to 5 graded aggregate
220 and over	10mm, 14mm or 20mm, nominal single-sized aggregate, or 14 to 5 or 20 to 5 graded aggregate

Alternatively, granular material in accordance with the following materials for bedding recommendations and having a particular size not exceeding that in Table 1 depending on pipe size, may be used.

## MATERIALS FOR BEDDING

### 1 VISUAL EXAMINATION

Examine the material and reject any which contains pieces with sharp edges.

### 2 PARTICLE SIZE

The maximum particle size should generally not exceed 20mm. The presence of an occasional particle between 20mm and 40mm is acceptable provided the total quantity of such particles is only a very small fraction. If particles over 40mm are present, the material should be rejected.

The following test will ensure compliance with this recommendation.

A weighed representative sample of the material, about 50kg of the proposed material should be subdivided to give a 2kg test sample which is sieved, using test sieves of 19mm and 38mm nominal mesh size (see BS410).

Note 1: To obtain a representative sample, about 50kg of the proposed material should be heaped on a clean surface and divided with a spade down the middle. One of these halves should then be similarly divided, and so on until the required sample is left.

Note 2: In the sieving, clumps of material that break up under light finger pressure may be helped through the sieve, but considerable force should not be used to squeeze oversize clumps through the mesh.

The material is not recommended if:

- a) any particles are retained on the 38mm sieve, or
- b) more than 5% by mass of the sample is retained on the 19mm sieve.

## EASE OF COMPACTION

### i) Apparatus:

The following apparatus is required

- a) Open-ended cylinder 250mm long and 150 ± 6mm internal diameter (160mm diameter unplasticized PVC pipe is suitable)
- b) Metal rammer with striking face 40mm diameter and weighing 1.0 ± 0.1kg
- c) Rule

### ii) Procedure

Obtain a representative sample (note 1) more than sufficient to fill the cylinder (about 11kg). It is important that the moisture content of the sample should not differ materially from that of the main body of material at the time of its use in the trench.

Place the cylinder on a firm flat surface and gently pour the sample material into it, loosely and without tamping. Strike off the top surface level with the top of the cylinder and remove all surplus spilled material. Lift the cylinder clear of its contents and place on a fresh area of flat surface. Place about one quarter of the contents back in the cylinder and tamp vigorously with the metal rammer until no further compaction can be obtained. Repeat with the second quarter, tamping as before, and so on for the third and fourth quarter, tamping the final surface as level as possible.

Measure down from the top of the cylinder to the surface of the compacted material. This distance in millimetres divided by the height of the cylinder (250mm) is referred to as the "compaction fraction".

## Interpretation of results

TABLE 2

Compaction fraction (equivalent measurement from the top of the cylinder, mm)	Suitability for use
<0.20 (50)	Material Suitable
>0.20<0.3 (50 to 75)	Material may be suitable for applications other than installation carried out in compliance with the Civil Engineering Specification for the Water Industry but requires extra care in compaction. Not suitable if the ground is subjected to waterlogged conditions after laying.
>0.3 (75)	Material Unsuitable

## PIPE LAYING

Unlike rigid pipes, pipes made from "flexible material" such as PVCu cannot be classified by their "crushing strength" but the fact that they are flexible does enable PVCu pipes to withstand forces from external loads and ground movement.

When a vertical load is imposed on a "flexible pipe" the resulting horizontal force is transmitted to the undisturbed trench wall by the sidefill. Any deflection of the pipe will cease when the horizontal reaction of the sidefill corresponds to the transmitted vertical load and a state of equilibrium is reached.

**FIGURE 6**  
**MAXIMUM AND MINIMUM RECOMMENDED DEPTHS**

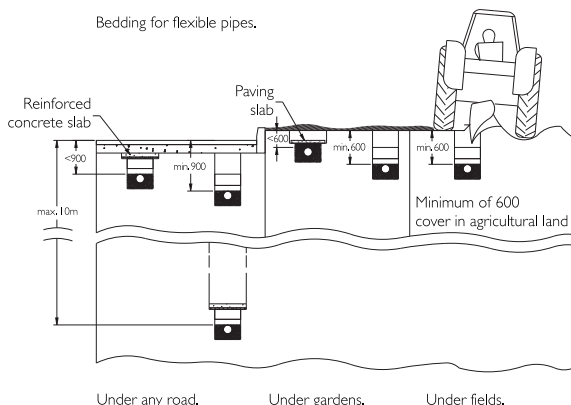

**SPECIAL PROTECTION - SETTLEMENT**

A drain which runs under a building should be surrounded by at least 100mm of granular or other flexible filling.

It is recommended that a drain, which passes through a wall or foundation, should either:-

- a) pass through an opening giving at least 50mm clearance all round as shown in Fig 7(a); or
- b) be built in with, on each side, flexible joints within 150mm and rocker pipes of maximum length 600mm as shown in Fig 7(b).
- c) wall protection sleeves are available shown Fig 7(c).

**FIGURE 7**  
**PIPES PENETRATING WALLS**

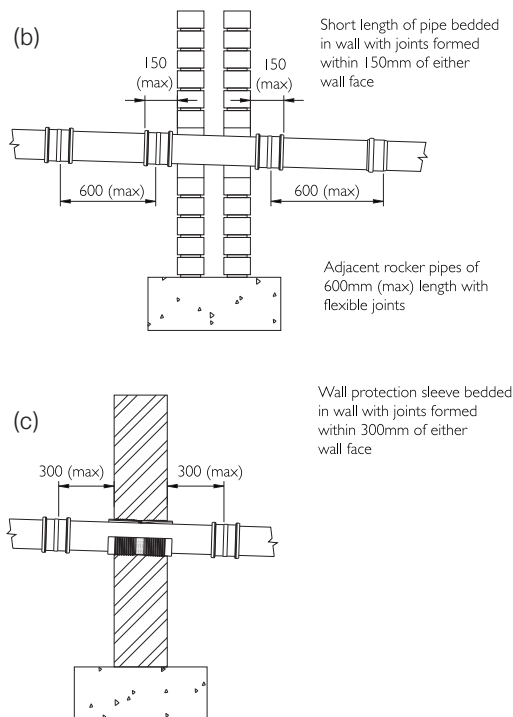
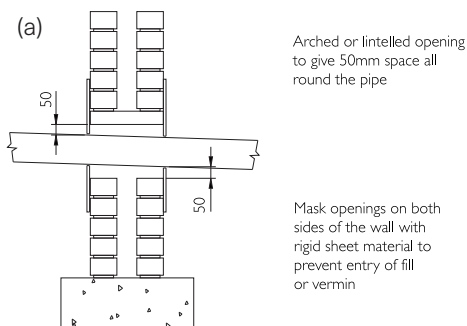

A drain which is at a level lower than the foundations of a building:-

- i) where the trench is within 1m of the foundations, it should be filled with concrete up to the level of the underside of the foundations; or
- ii) where the trench is more than 1m from the foundations, it should be filled with concrete to a level, below the level of the underside of the foundations, equal to the distance from the foundations less 150mm.

Flexible pipes must be wrapped in polythene before surrounding in concrete. The minimum thickness of the concrete surround should be 150mm or the diameter of the pipe, whichever is greater.

(Note: where a drain is to pass under a foundation it should be supported on piles, or where the ground is unstable, specialist advice should be sought on the required protective measures).

**SPECIAL PROTECTION - SURCHARGING**

Where a drain is liable to surcharge, protective measures as described in standard BS EN 752 should be used.



## ACCESS TO DRAINS

Access must be provided to drainage installations to allow for periodical maintenance, inspection and testing. Manholes, inspection chambers and shallow access chambers allow a system to be rodded in both directions whereas rodding eyes allow for only a downstream operation.

Basic principles state that every length of drain should be accessible for maintenance and rodding without the need to enter buildings. Access should be provided at the following points:

- i) At every change in direction

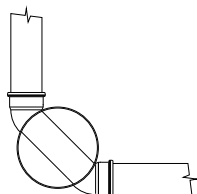

- ii) At the head of a drain

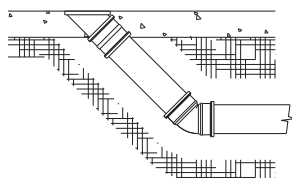

- iii) At any change in gradient

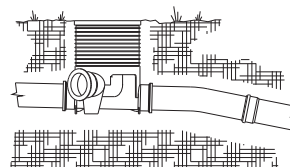

- iv) At any change in pipe diameter

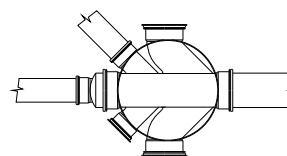

Table 3 indicates the maximum recommended spacing between various types of access points, based on standard rodding techniques and the necessity to clear blockages.

Where two drains join together via a branch junction and no provision of access is made on that junction then access should be provided no more than 12m from this point.

**TABLE 3**  
**MAXIMUM SPACING OF ACCESS POINTS**

Distance to	To junction/ branch	To access fitting	To inspection chamber	To manhole
	m	m	m	mm
From start of external drain	-	12	22	45
From rodding point	12	12	22	45
From access fitting	12	12	22	45
From inspection chamber	12	22	45	45
From manhole	-	-	45	90
As per National Annex to BS EN 752:2017				

The depth of any inspection chamber or manhole is determined by its minimum internal dimensions, since there must be adequate access or entry for rodding and maintenance. Details listed on Table 4.

TABLE 4  
**MINIMUM DIMENSIONS FOR ACCESS FITTINGS AND CHAMBERS**

Type	Depth to invert from cover level (m)	Internal sizes		Cover sizes	
		Length x width (mm x mm)	Circular (mm)	Length x width (mm x mm)	Circular (mm)
Rodding eye	-	As drain but min 100	-	-	same size as pipework <sup>1</sup>
Access fitting	0.6 or less except where situated in a chamber	small 150 diameter	150	150 x 100 <sup>1</sup>	same size as access fitting
150 x 100		150	150 x 100 <sup>1</sup>		
large 225 x 100		225	225 x 100 <sup>1</sup>		
Inspection chamber	0.6 or less 1.2 or less >1.2	Shallow	225 x 100	-	190 <sup>2</sup>
Deep		450 x 450	450	430	access restricted to max 350 <sup>3</sup>
		450 x 450	450	Min 430 x 430 Max 300 x 300 <sup>3</sup>	

Reference: The Building Regulations 2010, Approved Document H.

<sup>1</sup> The clear opening may be reduced by 20mm in order to provide proper support for the cover and frame.

<sup>2</sup> Drains up to 150mm.

<sup>3</sup> A larger clear opening cover may be used in conjunction with a restricted access. The size is restricted for health & safety reasons to deter entry.

**PREFORMED INSPECTION CHAMBERS**

Preformed inspection chambers can be used for invert depths of up to 3m, dependent on local specifications and building regulations. If the invert depth is greater than 1.2m this constitutes a no personnel entry Inspection Chamber and must have a restricted opening for health & safety reasons of less than 350mm to prevent personnel entry. The Reducer ring, code 6350, is available in such circumstances and should be fitted into the cover frame. The chamber should be placed on suitable compacted material so that it is evenly supported.

When the base is in position the bungs can be removed and pipes inserted as appropriate. The risers are then placed on the base to reach the desired invert. The top riser can be trimmed to suit finished ground level. It is recommended that the cover and frame are fitted at this point to stop any foreign matter from entering the chamber. Backfilling may then take place around the chamber base and the connecting pipes, using suitable granular material. Backfilling continues to within 160mm of ground level. A concrete plinth is then cast, in which the cast iron cover and frame sit.

FIGURE 8A.

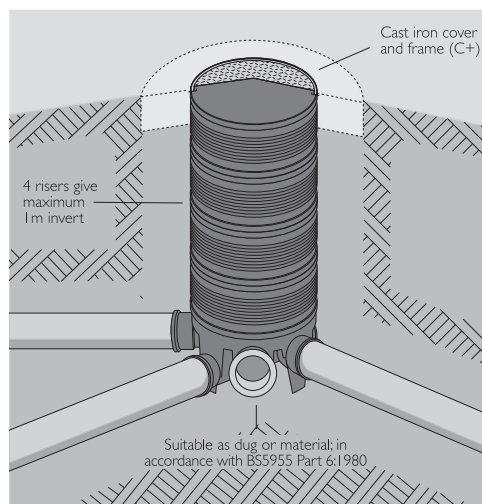

The straight through channel should be used for the main flow at all times as illustrated above. This reduces the likelihood of cross flow and helps show direction of flow for rodding purposes.

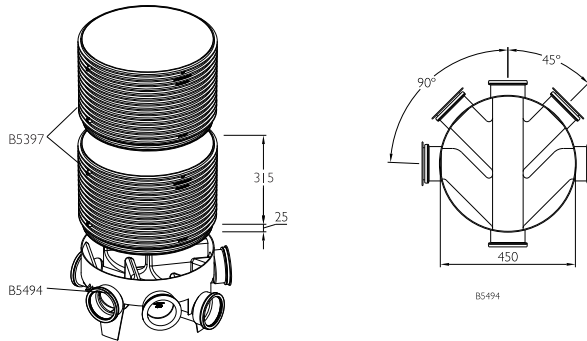

Product codes - Chamber Base B5494  
Sectional Riser B5397

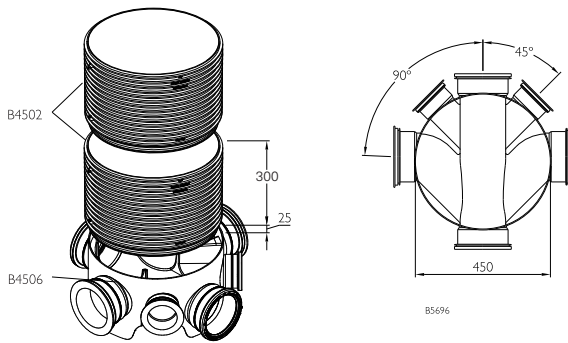

Radius on 90°/160mm inlets improves flow through the chamber.

Product codes - Chamber Base B4506  
Sectional Riser B4502

Figure 8b illustrates some of the alternative configurations available when using pre-formed inspection chambers.

FIGURE 8B.

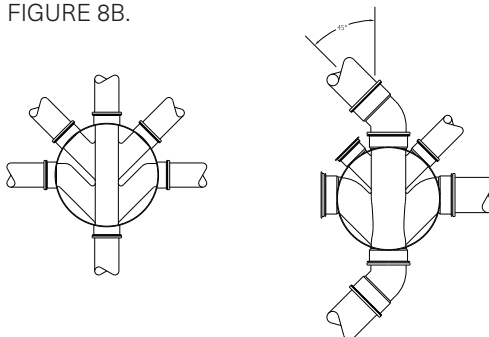

N.B. When turning through 90°, 2N° x 45° bends should be used as above, to incorporate the main channel throughout the change of direction.

TABLE 5  
**INSPECTION CHAMBER 450 mm X 110mm  
& 450 X 160mm - KEY DIMENSIONS**

INSPECTION CHAMBER – KEY DIMENSIONS (mm)				
Socket Diameter	Standard		to EN13598-1	
	110mm	160mm	110mm	160mm
Chamber Base Diameter	450	450	450	450
Chamber Base Product Code	B5494	B5696	B4500	B4506
Invert Depth of Base	225	255	225	255
Invert Depth of Riser	315	315	300	300
Invert Depth of Base and 1 Riser	540	570	525	555
Invert Depth of Base and 2 Risers	855	885	825	855
Invert Depth of Base and 3 Risers	1170	1200	1125	1155
Round Cover and Frame	33	33	33	33
Square Cover and Frame	48	48	48	48

TABLE 6  
**NO ENTRY PERSONNEL  
INSPECTION CHAMBER 450 mm X 110mm  
& 450mm x 160mm - KEY DIMENSIONS**

INSPECTION CHAMBER – KEY DIMENSIONS (mm)		
Socket Diameter	to EN13598-1	
	110mm	160mm
Chamber Base Diameter	450	450
Chamber Base Product Code	B4500*	B4506*
Invert Depth of Base and 4 Risers	1425	1455
Invert Depth of Base and 5 Risers	1725	1755
Invert Depth of Base and 6 Risers	2025	2055
Invert Depth of Base and 7 Risers	2325	2355
Invert Depth of Base and 8 Risers	2625	2655
Invert Depth of Base and 9 Risers	2925	2955
Round Cover and Frame	33	33
Square Cover and Frame	48	48

NB: Restricted opening of 350mm diameter at ground level must be employed for chambers deeper than 1.2m

TABLE 7  
**SHALLOW ACCESS CHAMBER 280 mm &  
315mm - KEY DIMENSIONS**

SHALLOW ACCESS CHAMBER – KEY DIMENSIONS (mm)			
Socket Diameter	110mm	Standard	to EN13598-1
		110mm	110mm
Chamber Base Diameter	280	315	315
Chamber Base Product Code	B2800	B1350	B3156*
Invert Depth of Base	205	190	190
Invert Depth of Riser	185	185	185
Invert Depth of Base and 1 Riser	390	375	375
Invert Depth of Base and 2 Risers	575	560	560
Cover and Frame	20.5	27.5	27.5

**SHALLOW ACCESS CHAMBERS**

The Brett Martin 280mm and 315mm dia Shallow Access Chambers are designed for use with 110mm pipework and are suitable for inverts up to 600mm.

The 280mm Chamber range offers two different bases, code B2800 incorporating one 45° inlet on each side and code B2803, which features a 90° change of direction of the main channel.

The more versatile 315mm dia base offers one 45° and one 90° inlet connection on each side and can, where suitable, reduce costs significantly by replacing the larger 450mm Inspection Chamber. Applicable to maximum inverts of 600mm only.

Chamber Risers for both assemblies incorporate ring seals that allow easy push fit joints between the base and each other. It is strongly recommended that lubricant is always used in making a ring seal joint. (See page 34 for options.) Each Riser adds 185mm to the Chamber assembly, with a maximum of two risers to be used. The 315mm dia Chamber Cover and Frames have long, ring sealed spigots that allow in certain circumstances for only one riser to be used.

The Cover and Frame code B2802, features a double seal and can be used internally, if required. When used externally, location must be in a pedestrian area only. However, the 315mm Chamber range includes two Cover and Frames, code B3153 for Pedestrian areas and a cover and frame, code B3154, which can be located in domestic driveways. Both 315mm dia Cover and frames feature double seals. It is recommended that all frames are located in a concrete plinth for stability and to spread the loading when used in a driveway location.

Another feature of the 315mm Cover and Frame is that the longer spigot allows for an offset connection to the Chamber Riser, to enable the cover to follow a sloping surface up to 15°.

All three Covers and Frames are square and are easily incorporated into paving or tarmac.

FIGURE 9

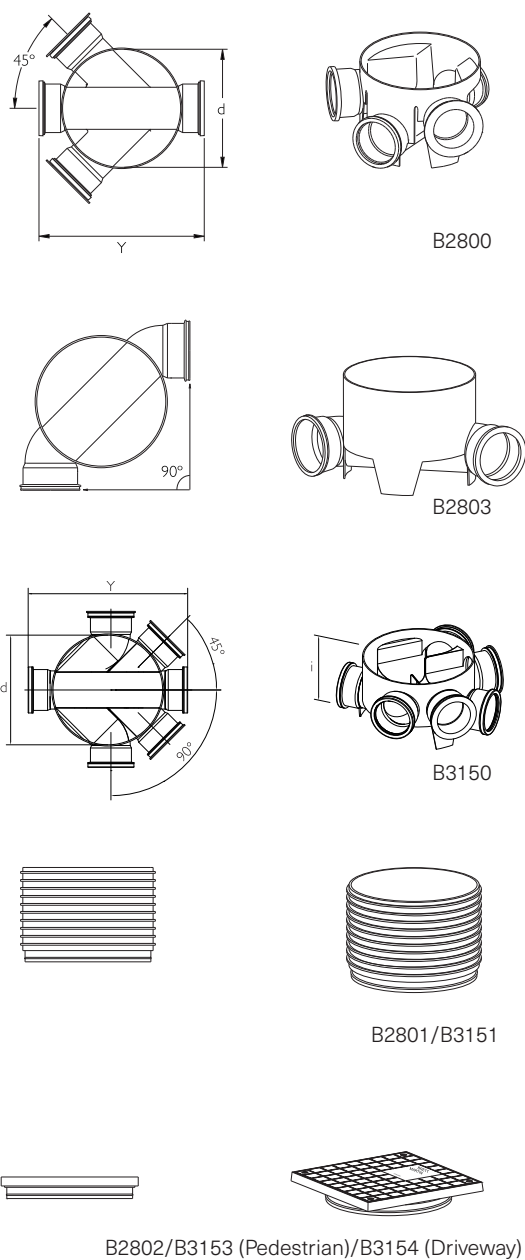

## ACCESS AND INSPECTION CHAMBERS

Ensure that the base is embedded on a suitable substrate. This should either be suitable “as dug” material or materials in accordance with BS EN 1610:2015.



Check that the spigot on the riser is free from imperfections such as dents, burrs or cracks.

Clean both the spigot on the riser and the seal to ensure that they are free from any dirt which may impede their function.

When fitting the seal to the riser be careful not to stretch the seal any more than is required to fit it into the recess.



Add some lubricant around the seal and run your thumb around the seal to both ensure that the seal is housed in its groove/recess and to wipe away any excess lubricant.

Place the riser on top of the base/riser to which it will be fitted. The riser should be positioned so that seal sits on top of the chamber/riser below.

Position both hands diametrically opposed to one another and apply even pressure to push the riser downwards into the base/riser below until it is completely fitted. Ensure that the riser is inserted square to its axis and not fitted at an angle as this may push the seal out of its recess.

Check that the riser/base has no raised areas any deflection in front of the seal as this may indicate that the seal is dislodged.

Once the riser is in place, cable ties (or similar) can be used on the integral lugs on the side of both riser and bases. These are positioned between both base and riser or riser and riser in order to ensure that the riser cannot “pop out” of the base/riser below it during backfilling.



Care should be taken when backfilling so the chamber assembly is not disrupted by excessively or unequally backfilling.<sup>a</sup>

It is recommended that inspection chamber assemblies are water tested and visually inspected prior to backfill to ensure leak tightness.<sup>a b</sup>

Further water testing is also recommended once installation is complete.<sup>a b</sup>

<sup>a</sup> To be carried out in accordance with BS EN 1610:2015.

<sup>b</sup> Water testing requirement on installations is subject to local/national building regulations

## OPEN CHANNEL MANHOLES

Brett Martin chamber bases can be used in the bottom of a constructed manhole arrangement. The chamber base is positioned carefully in concrete to give full support throughout its diameter. Benching is sloping upwards from the base to the manhole walls at a gradient of 1:12. All construction must be in accordance with BS EN 752, Figure 10.

FIGURE 10

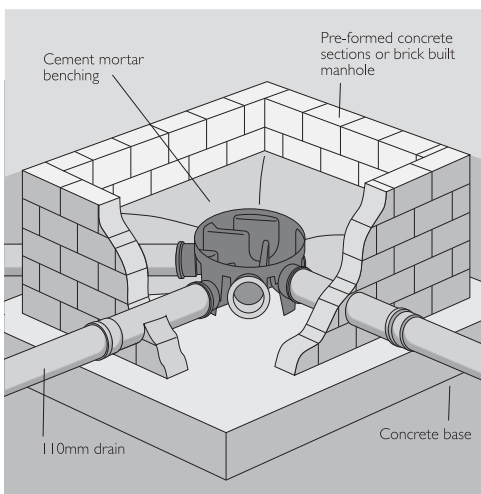

A large range of  $\frac{1}{2}$  and  $\frac{3}{4}$  channel fittings offer the contractor a wide choice of constructional methods.

Fittings are available in 110mm, 160mm and 200mm diameters. Channel fittings for larger bore pipe can be fabricated on request.

Two systems are available:

- (i) Level invert system Figure 11
- (ii) Stepped invert system Figure 12

A level invert system is advantageous when invert levels need to be accurate. The range consists of junctions, bends, tapers which have to be solvent welded into position. No solvent welding is required on a stepped invert system.

FIGURE 11

## LEVEL INVERT SYSTEM

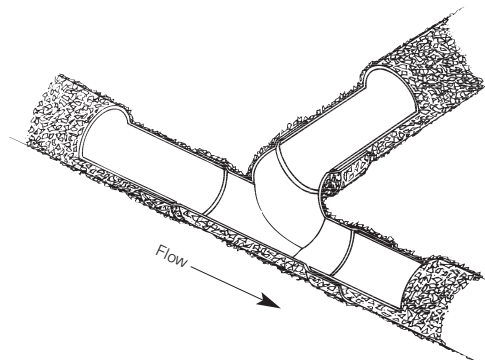
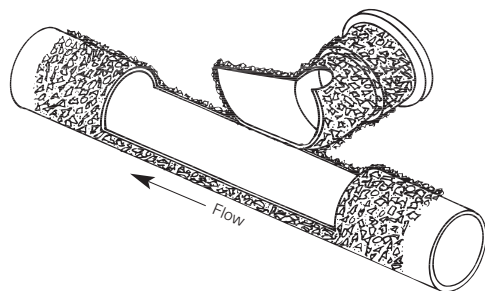

FIGURE 12

## STEPPED INVERT SYSTEM



Solvent welding must be carried out in the following way to ensure a sound and lasting joint:

- (i) All spigot ends must be square and chamfered
- (ii) Both surfaces should be free from dirt and water
- (iii) With a clean brush apply Brett Martin Solvent Cleaner to both surfaces and allow to dry
- (iv) Again with a clean brush apply an even coat of Brett Martin Solvent Cement
- (v) Immediately insert the coated spigot into the socket and hold in place for about a minute

N.B. A narrow cut-off pipe may be sprung into the joint to hold the assembly in position. See Figure 13, but it must be removed when the joint is set.

FIGURE 13  
**SOLVENT WELDING**

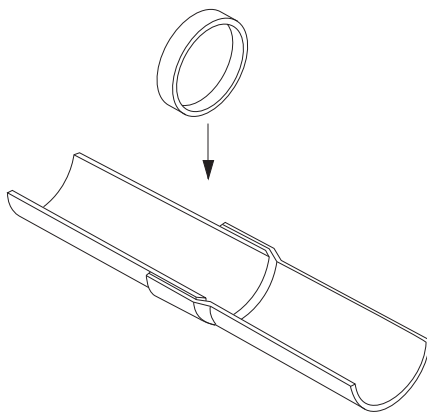

The full range of Brett Martin Channel Fittings are supplied with a keyed surface, to ensure excellent adhesion to the concrete benching.

FIGURE 14  
**ILLUSTRATES ALTERNATIVE ASSEMBLIES**

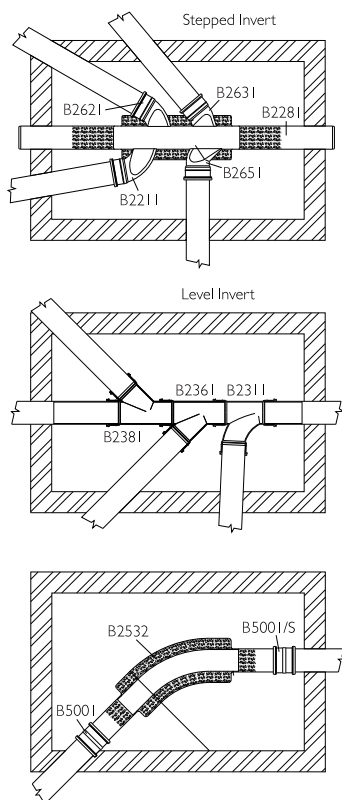

Many additional combinations are possible using the above and other Open Channel Fittings.

**BACKDROP MANHOLE CONSTRUCTION**

A backdrop installation is required when two or more pipes, at different invert levels, are to meet at one manhole. Minimum trench excavation is therefore needed to join the pipework together.

The vertical section of a backdrop can be constructed internally or externally.

FIGURE 15  
**INTERNAL BACKDROP**

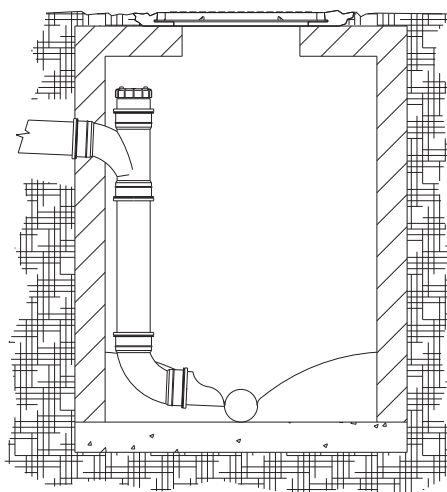

**INTERNAL CONSTRUCTION**

To construct an internal backdrop as illustrated in Figure 15 use:

- 1 No B5091 - Screw Access Cover
- 1 No B4081 - 87<sup>1</sup>/<sub>2</sub>° Triple Socket Branch
- 1 No B5041 - Single Socket Bend 87<sup>1</sup>/<sub>2</sub>° section of pipe for vertical drop

The vertical section should be securely fixed to the manhole wall using Pipe/Socket Fixing Brackets (BS407) from the Brett Martin Soil Range, and held with stainless steel screws.



FIGURE 16  
**EXTERNAL BACKDROP**

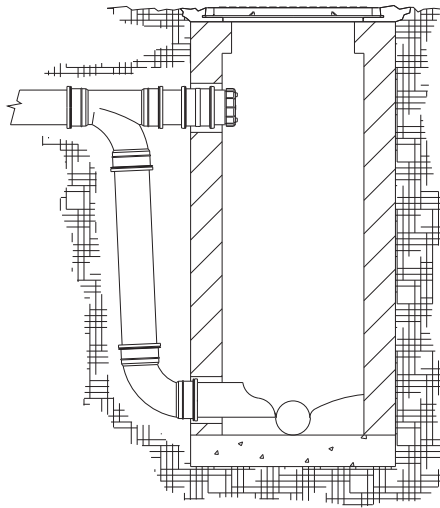

**EXTERNAL INSTALLATION**

The vertical section of the installation is this time outside the chamber wall. The fittings required to construct an external backdrop are as shown in Figure 16:

- 1 No B5091 - Screw Access Cover
  - 1 No B4081 - 87½° Triple Socket Branch
  - 1 No B5001 - Pipe Coupler
  - 1 No B4031 - Double Socket Bend 87½°
- plus a suitable section of vertical pipe

Note: 160mm installations may be constructed using similar 160mm fittings.

**RODDING ACCESS**

When installed correctly, the use of rodding points can eliminate the need for expensive Inspection Chambers and Manholes, significantly reducing the cost of installation.

**HEAD OF DRAIN RODDING POINT**

A Rodding Point as shown in Figures 17 and 18 can be used at the head of a drain in place of an inspection chamber or manhole. The rodding eye itself is made from cast alloy and has a 110mm spigot allowing easy connection to the system. Being set at 45° it allows easy rodding of the system.

FIGURE 17  
**HEAD OF DRAIN RODDING POINT**

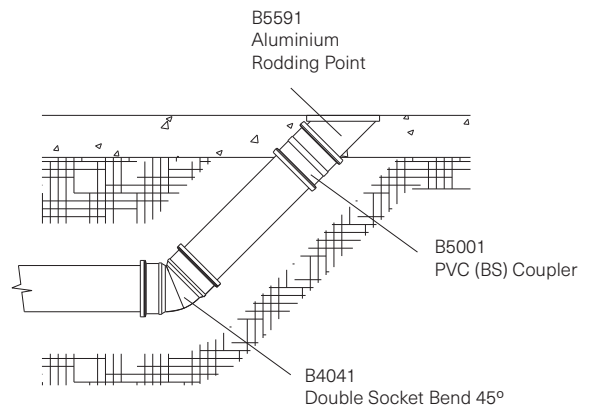

NB Sealed square and socketed version of the aluminium rodding point is also available code B5592.

FIGURE 18

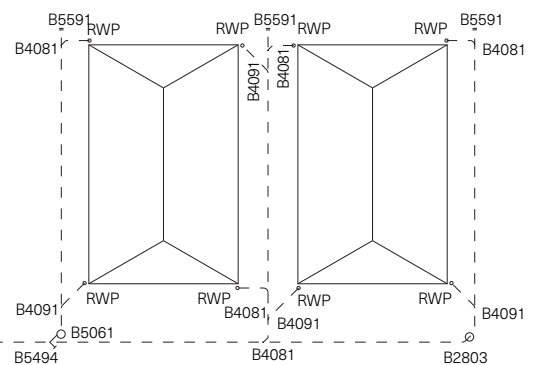

Shows how Rodding Points can minimise the number of inspection chambers and manholes on a typical surface water application.



**UNIVERSAL RODDABLE  
BOTTLE GULLY**

The Brett Martin Universal Roddable Bottle Gully (as shown in Figure 19), may be used with a wide range of grids and sealing plates. It may be rotated leaving the grid square to the wall thus giving a more direct line of drainage resulting in economy of fittings.

A full 100mm diameter access, gained by the removal of the dip tube, enables a wide range of cleaning equipment to be used.

The unit can be used instead of a traditional gully assembly and in certain applications, can remove the need for an inspection chamber, Figure 19.

**FIGURE 19  
RODDABLE BOTTLE GULLY  
INSTALLATION DETAILS**

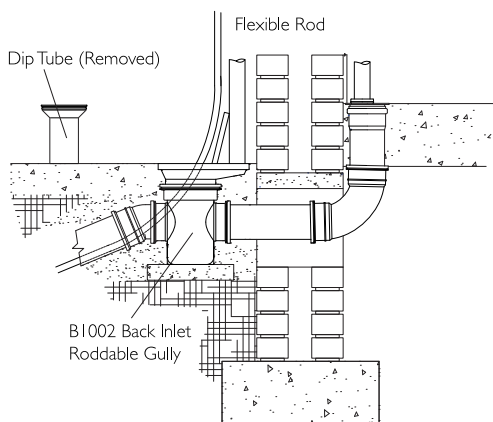

NB: All appliances connected to the black inlet of the bottle gully must be trapped separately

**FIGURE 20  
HOW A RODDABLE BOTTLE GULLY CAN  
ELIMINATE THE USE OF INSPECTION  
CHAMBER OR MANHOLES**

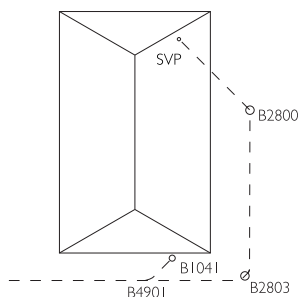

**RODDING ACCESS**

In areas where combined foul and surface water systems are permitted, the rainwater connections must be trapped. See Figure 21.

Concrete Floor Construction

**FIGURE 21  
TYPICAL LAYOUT USING RODDING  
ACCESS COMPONENTS**

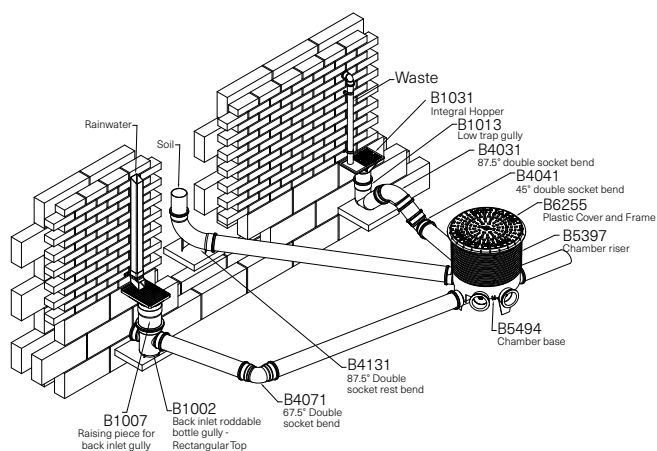

**USEFUL INSTALLATION TIPS**

- Always chamfer cut pipe and lubricate all plain ended spigots for perfect joints.
- Storm water connections are invariably less critical than those in the foul system. Therefore lay the foul drain system closest to the building and lay the storm system around this wherever possible.
- Where external soil stacks are connected to the side inlet of a preformed chamber, ensure that the distance between the two is a minimum of 750mm to help prevent cross flow of solids onto the opposite benching.
- Where combined drainage systems are installed ensure each rainwater pipe is connected to a gully.
- Always use the main channel of a chamber at a change of direction of the main run.

FIGURE 22  
**TYPICAL INSTALLATION (ENGLAND & WALES) - SURFACE WATER SYSTEM ONLY**

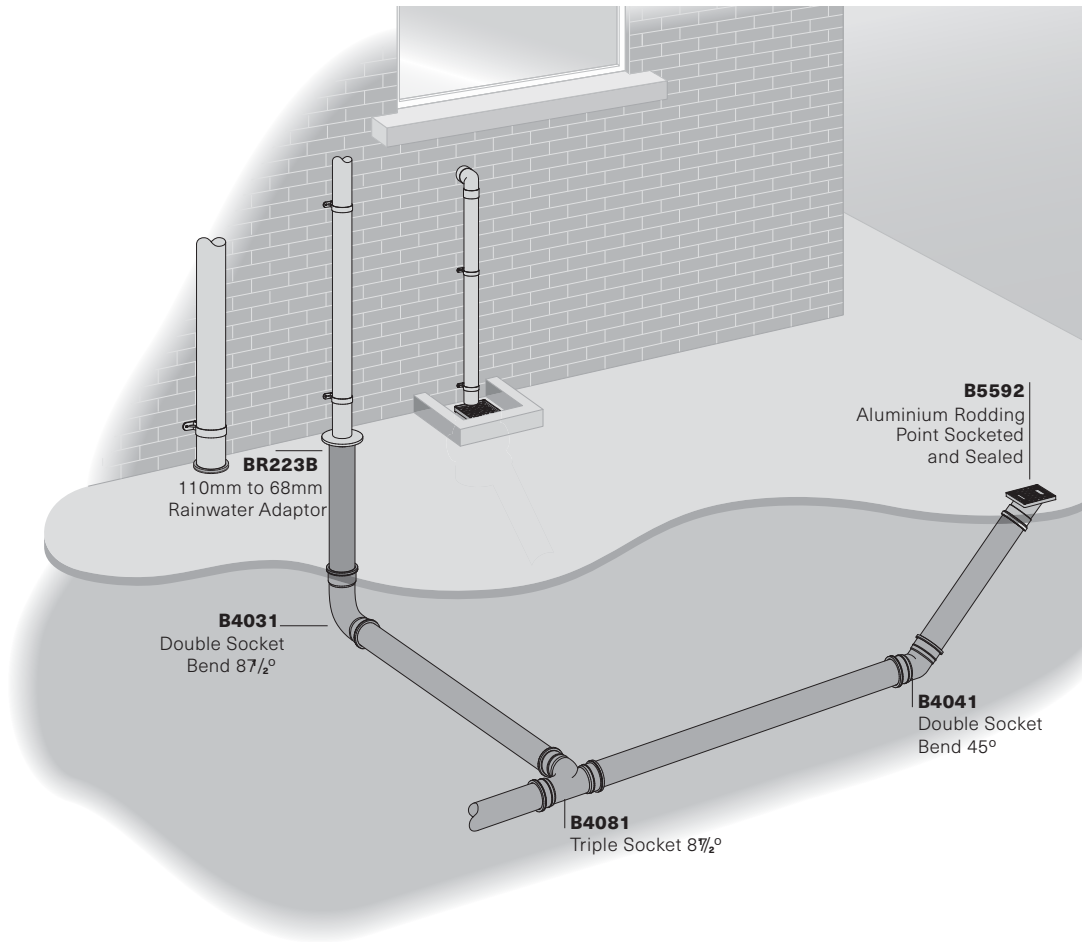

**TRADITIONAL GULLY ASSEMBLY**

The Low Trap Gully can be supplied in basic assembled form with a wide range of bends offering a choice of outlet.

The hopper should be attached to the trap out of the ground, and the whole assembly should be placed on a ready-made concrete slab, connected to the main drain, and backfilled with a selected granular material.

If the assembly is not protected by pavings or concrete at ground level e.g. in a garden, then a concrete slab should be bedded above the outlet bend to prevent damage from garden implements, Figure 23.

FIGURE 23  
**TRADITIONAL GULLY ASSEMBLY**

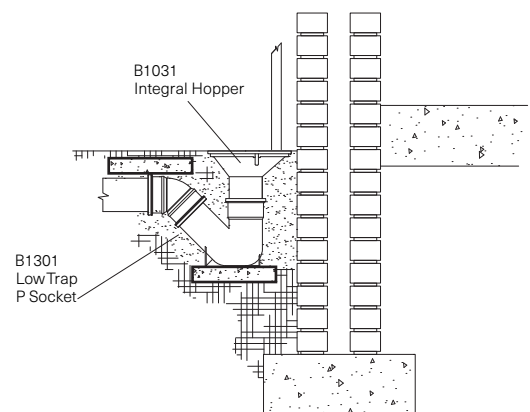

**HORIZONTAL BACK INLET ASSEMBLY**

Figure 24 shows the use of the Horizontal Back Inlet Hopper when collecting waste water from inside a building.

Gully risers can be used with the whole range of square hoppers and bottle gully when extra depth is necessary. The rest of the gully assembly is as the aforementioned installation.

FIGURE 24  
**HORIZONTAL BACK INLET ASSEMBLY**

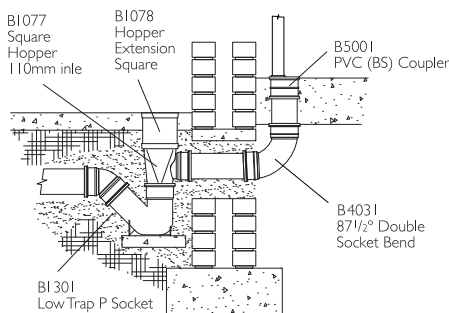

**BOTTLE GULLY ASSEMBLY**

The unique round to square adaptor enables the gully outlet to be rotated leaving the grid square to the wall thus giving a more direct line of drainage.

The base design allows the gully to stand freely on a firm base of bricks or concrete without additional support.

It has two bosses which will accept a 110mm pipe when the need for the true back inlet arises.

Installation is completed by bedding and surrounding the gully with selected granular material, Figure 25.

FIGURE 25  
**BOTTLE GULLY ASSEMBLY**



NB: All appliances connected to the back inlet of the bottle gully must be trapped separately.

**SOIL PIPE CONNECTION (SHORT RADIUS)**

Figures 26(a) and (b) show how to connect an internal soil stack to an underground drainage system using a two way knuckle bend.

FIGURE 26(a)  
**USUAL SOIL PIPE CONNECTION**

Suitable where WC's are connected to the soil stack, the rest bend B4131 should be used.

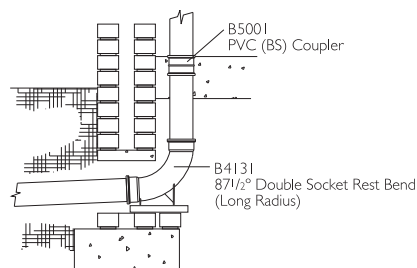
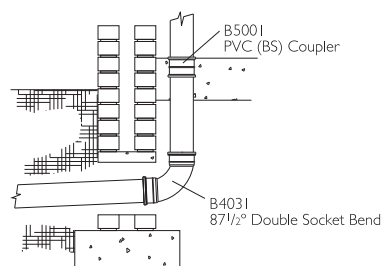

FIGURE 26(b)  
**SOIL PIPE CONNECTION (SHORT RADIUS)**

Suitable where WC's are not connected to the soil stack. The pipe is then taken to ground level and connected to the stack with a coupler.



## SOIL PIPE CONNECTION (LONG RADIUS)

Figure 27 again shows the connection of underground drain to soil by the use of a long radius bend connected together with two couplers.

It is advisable to use a long radius bend when heavy or fast flows are expected e.g. flats (multi-storey dwellings).

FIGURE 27

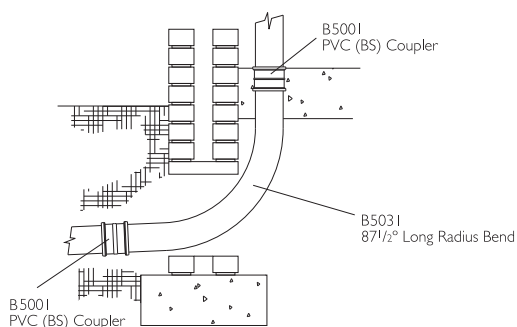

## RAINWATER PIPE CONNECTIONS

If rainwater pipes are to be situated externally then connections can be made by fitting a rainwater pipe adaptor to a pipe and via a knuckle bend as shown in Figure 28. Should the system be combined the rainwater pipe would have to be dropped into a trap assembly similar to that shown in Figure 23.

FIGURE 28

## RAINWATER PIPE CONNECTIONS

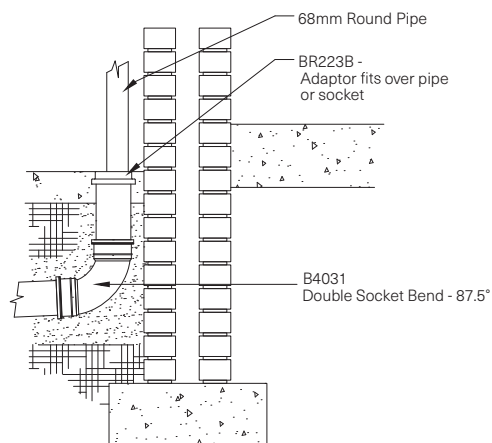

## SADDLE BRANCH

### BRANCH ENTRIES

To make new connections to existing 110mm and 160mm PVCu drains insert a suitable Junction and Slip Couplers.

To insert a new branch entry into larger diameter drains use a Saddle Junction, Solvent Weld is available in the Brett Martin range.

Solvent Weld Saddle Junctions are supplied in 110mm and 160mm sizes for 45° and 87 1/2° Branch entries and 200mm for connection at 45°.

FIGURE 29

### 200mm X 110mm CONNECTIONS AT 45° USING SOLVENT WELD JUNCTION ON 200mm DRAIN

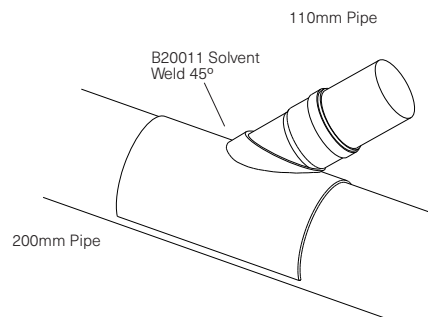

## PIPE JOINTS

The Brett Martin Drainage system includes Adaptors to connect PVCu to clay or cast iron sockets or spigots. These connections are illustrated in Figures 30-33.

FIGURE 30

### PVCu STANDARD CLAY ADAPTOR (B3500)

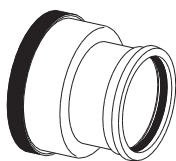

FIGURE 31

### PVCu SUPER CLAY ADAPTOR (B3510)

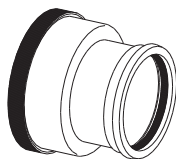

FIGURE 32

### SALT GLAZE SOCKET ADAPTOR (B5131/B7161)

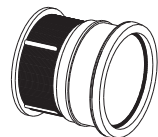
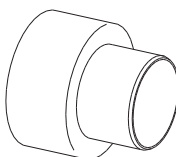

FIGURE 33

### SALT GLAZE SPIGOT ADAPTOR (B5141/B7151)



## CUTTING

Pipes can be cut with a hand saw having 6-8 teeth per cm, held at a shallow angle and sawing with slow steady strokes. A file should be used to remove any swarf and a chamfer should be made around the full circumference of the pipe.

## PUSH-FIT JOINTING

To ensure watertight jointing the following procedure should be followed:

- Pipe ends should be cut square. Chamfer the end to approximately half the wall thickness and at an angle of about 15° using a file or rasp. Remove all swarf with a scraper or knife blade. Chamfers are moulded on spigot ends of all fittings.

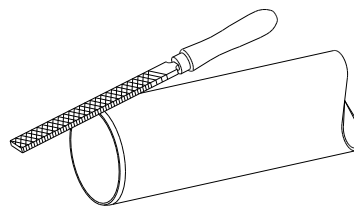

- Check all seals, sockets on pipes and fittings and pipe ends, for a distance equivalent to socket depths, are clean.
- Apply Brett Martin lubricant around the pipe end or spigot end of fittings - not around the ring seals.
- Align components and push the pipe end or fitting spigot fully into the ring seal socket to the depth of entry mark; mark the pipe or fitting spigot at the socket face.

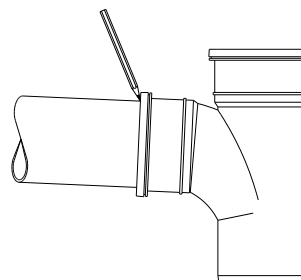

- Withdraw the pipe or spigot until the mark is 10mm away from the socket face: this creates a thermal movement allowance within the socket.

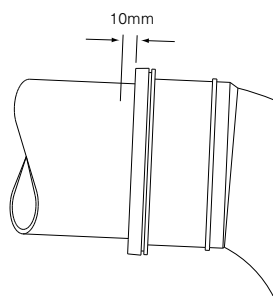

Make a subsequent check to ensure that the expansion gap is not lost during further installation work.

## PERFORATED PIPE

Perforated pipes are available in 53.9mm to 400mm and are supplied in single socketed 6 metre lengths only.

Perforated pipes are normally used in French drain applications, draining rainfall from paved or concreted areas such as roads, car parks, airfields etc. The camber of the paved or concreted area runs rainfall into the permeable fill above the perforated pipe. Highway drainage systems for example usually include French drains on both sides of the carriageway and in the central reservation.

## PERFORATED RIGID PIPES

### INSTALLATION OF PERFORATED RIGID PIPES AS A FRENCH DRAIN

- Install Perforated Pipes as other Brett Martin pipes but use a selected permeable fill as bedding, sidefill and backfill material, Figure 34.
- Do not compact the bedfill.

FIGURE 34

## FRENCH DRAIN

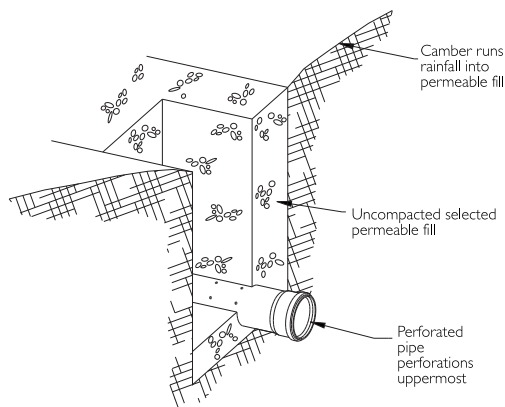

### SEPTIC TANK LEACH PIPE INSTALLATION USING PERFORATED RIGID PIPES

Brett Martin Perforated Pipes may be used to dispose of septic tank effluent by sub-surface irrigation.

- Lay pipes in trenches with a uniform gradient not steeper than 1:200 from the septic tank outlet.
- Install unperforated Brett Martin pipe with a fall of 1:30 for the first 3 metres. Installing an Inspection Chamber at this point will make it easier to monitor land drainage.
- Lay the pipes on, and surround them with a 150mm layer of clinker, clean gravel or broken stone 20mm - 50mm grade. Consult the septic tank manufacturer for advice on whether to position the perforations upwards or downwards in the trench.
- Place a layer of polythene sheet over the perforated pipe before backfilling.
- Do not use pipes manufactured in accordance with BS4962 for disposing of septic tank effluent.

A herringbone pattern is commonly used (see Figure 35). A percolation test is carried out to determine the area of land needed for effluent disposal.

FIGURE 35  
**SEPTIC TANK INSTALLATION SHOWING  
HERRINGBONE LAYOUT OF PIPES**

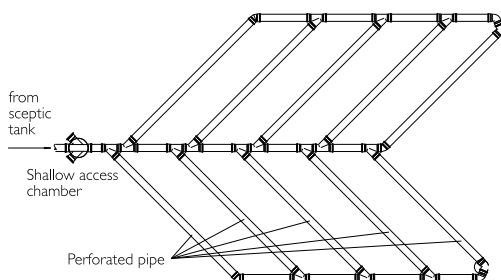

## SOLVENT CEMENT JOINTING

To ensure a permanent solvent cement joint, the following procedure should be followed:

1. When a solvent joint involves a pipe, the pipe end must be cut square and all burrs and rough edges removed.
2. Clean both surfaces to be joined, making sure they are free from dirt, grease and water.
3. With a clean brush apply Brett Martin Solvent cleaner.
4. Again, with a clean brush apply Brett Martin solvent cement to both surfaces to be joined: apply the solvent cement along the surface, not around it.
5. Immediately insert the coated pipe end or fitting spigot into the coated fitting socket, using a slight twist motion to ensure correct spread of adhesive and removal of air bubbles. If cemented surfaces are left unjoined for longer than 90 seconds, bonding will not be totally effective.

6. Hold the joint still for 30 seconds for initial bonding to take place; wipe off excess solvent cement; leave for a further 2 hours to gain strength. Do not test for at least 24 hours.

Do not thin Solvent Cement or Solvent Cement Filler. As these cements are solvent based it is essential to observe the normal precautions for solvents.

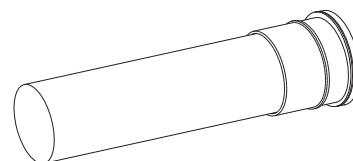
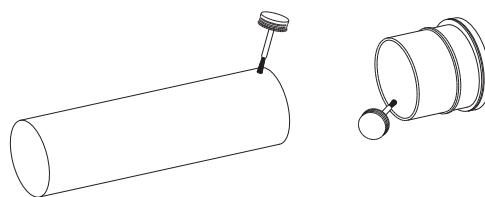

## CONNECTION TO UNDERGROUND DRAINAGE

Connection to PVCu drain socket.

It is possible to connect the 110mm Soil Stack to a PVC underground drainage system: where this is of greater diameter, an adaptor must be used.

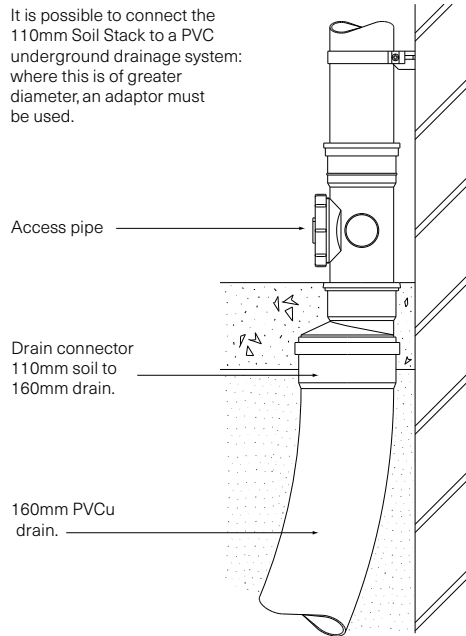

Connection to PVCu drain spigot.

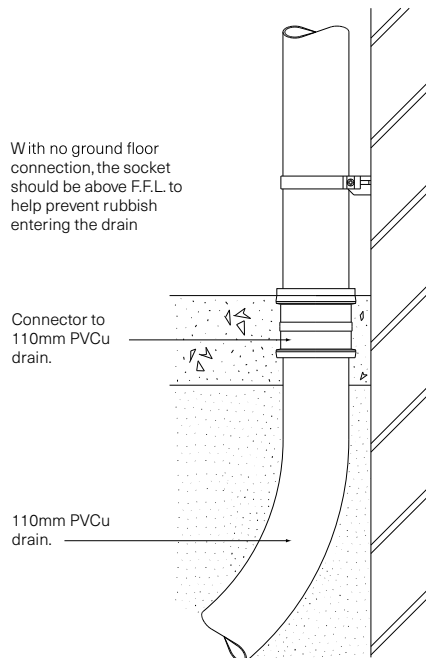

With no ground floor connection, the socket should be above F.F.L. to help prevent rubbish entering the drain

Connection to cast iron drain socket.

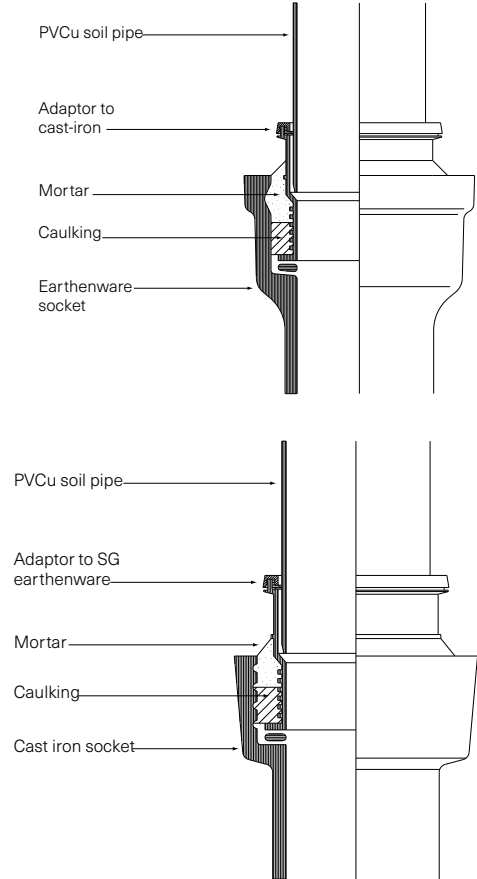

## MAINTENANCE

When designed and installed correctly the Brett Martin Drain and Sewer systems are maintenance free. However, as small bore drains are more likely to block through misuse, a comprehensive range of preformed inspection chambers, shallow access chambers, access fittings and rodding eyes are available.

Before any methods of access are adopted the Local Authority must be consulted to ascertain their own specific requirements.

Conventional rods, implements and specialist power assisted equipment may be used for cleaning a PVCu drain. It is necessary to ensure that cleaning equipment, particularly the end implement, will not cause damage to the pipe and fitting walls.

Should it become necessary to repair or extend a drainage system then use of a Brett Martin Slip Coupler - Code B5001S/B7001S can be made. In diameters exceeding 160mm a range of wedged or solvent weld saddle branches are available.



## CHEMICAL RESISTANCE

KEY:

+ good resistance

- poor resistance

Chemical name      Resistance  
   at 23°C

Acetaldehyde 40%	+	Aniline	-	Carbon disulphide	-
Acetaldehyde 100 %	-	Aniline chlorohydrate	-	Carbon dioxide	+
Acetic acid 10%	+	Aniline hydrochloride	-	Carbon monoxide	+
Acetic acid 20%	+	Anthraquinone sulphonc acid	+	Carbon tetrachloride	+
Acetic acid 80%	+	Antimony trichloride	+	Carbonic acid	+
Acetic acid, glacial	+	Aqua regia	+	Castor oil	+
Acetic anhydride	-	Aromatic hydrocarbons	-	Caustic potash	+
Acetone	-	Arsenic acid 80%	+	Caustic soda	+
Adipic acid	+	Arylsulphonic acid	+	Chloroacetic acid	+
Allyl alcohol 96%	+	Barium carbonate	+	Chloral hydrate	+
Allyl chloride	-	Barium chloride	+	Choric acid 20%	+
Alum	+	Barium hydroxide	+	Chlorine (dry)	-
Aluminium alum	+	Barium sulphate	+	Chlorine (wet)	-
Aluminium chloride	+	Barium sulphide	+	Chlorine water	+
Aluminium fluoride	+	Beer	+	Chlorobenzene	-
Aluminium hydroxide	+	Beer sugar liquors	+	Chloroform	-
Aluminium oxychloride	+	Benzaldehyde 10%	+	Chlorosulphonic acid	+
Aluminium nitrate	+	Benzaldehyde, above 10%	-	Chrome alum	+
Aluminium sulphate	+	Benzene	-	Chromic acid 10%	+
Ammonia gas (dry)	+	Benzine	+	Chromic acid 50%	-
Ammonia, liquid	-	Benzoic acid	+	Citric acid	+
Ammonium acetate	+	Bismuth carbonate	+	Copper carbonate	+
Ammonium alum	+	Bleach 12% Cl	+	Copper chloride	+
Ammonium bifluoride	+	Borax	+	Copper cyanide	+
Ammonium carbonate	+	Boric acid	+	Copper fluoride	+
Ammonium chloride	+	Bromic acid	+	Copper nitrate	+
Ammonium fluoride 25%	+	Bromine liquid	-	Copper sulphate	+
Ammonium hydroxide	+	Bromine water	+	Cottonseed oil	+
Ammonium metaphosphate	+	Butadiene	+	Cresol	+
Ammonium nitrate	+	Butane	+	Cresylic acid	-
Ammonium persulphate	+	Butanol normal	+	Crotonaldehyde	-
Ammonium phosphate	+	Butanol iso	+	Crude oil	+
Ammonium sulphate	+	Butyl acetate	-	Cupric fluoride	+
Ammonium sulphide	+	Butyl phenol	+	Cupric sulphate	+
Ammonium thiocyanate	+	Butyric acid	+	Cuprous chloride	+
Amyl acetate	-	Cadmium cyanide	+	Cyclohexanol	-
Amyl alcohol	+	Calcium bisulphite	+	Cyclohexanone	-
Amyl chloride	-	Calcium carbonate	+	Detergents	+
		Calcium chlorate	+	Dextrin	+
		Calcium chloride	+	Dextrose	+
		Calcium hydroxide	+	Diazo salts	+
		Calcium hypochlorite	+	Diglycolic acid	+
		Calcium nitrate	+	Dimethylamine	+
		Calcium oxide	+	Diocetyl phthalate	-
		Calcium sulphate	+	Disodium phosphate	+

## CHEMICAL RESISTANCE

Distilled water	+	Hydroxylamine sulphate	+	Nickel nitrate	+
Esters	-	Hypochlorous acid	+	Nickel sulphate	+
Ethers	-	Iodine	-	Nicotine	+
Ethyl acetate	-	Kerosene	+	Nicotine acid	+
Ethyl acrylate	-	Ketones	-	Nitric acid, anhydrous	-
Ethyl alcohol	+	Lactic acid 25%	+	Nitric acid 10%	+
Ethyl chloride	-	Lauric acid	+	Nitric acid 60%	+
Ethyl ether	-	Lauryl chloride	+	Nitric acid 68%	+
Ethylene bromide	-	Lead acetate	+	Nitrobenzene	-
Ethylene chlorohydrin	-	Lead chloride	+	Nitrous oxide	+
Ethylene dichloride	-	Lead sulphate	+	Oils and fats, vegetable	+
Ethylene glycol	+	Lead tetraethyl	+	Oleic acid	+
Ethylene oxide	-	Linoleic acid	+	Oleum	-
Fatty acids	+	Linseed oil	+	Oxalic acid	+
Ferric chloride	+	Lithium bromide	+	Oxygen	+
Ferric hydroxide	+	Lubricating oil	+	Ozone	+
Ferric nitrate	+	Machine oil	+	Palmitic acid	+
Ferric sulphate	+	Magnesium carbonate	+	Paraffin	+
Ferrous chloride	+	Magnesium chloride	+	Perchloric acid 10%	+
Fluoboric acid	+	Magnesium citrate	+	Perchloric acid 15%	+
Fluorine gas (wet)	+	Magnesium hydroxide	+	Perchloric acid 70%	+
Fluorine gas (dry)	+	Magnesium nitrate	+	Petrol	+
Fluosillicic acid 25%	+	Magnesium sulphate	+	Petrol high octane	+
Formaldehyde	+	Maleic acid	+	Phenol	+
Formic acid	+	Malic acid	+	Phenylhydrazine	-
Fructose	+	Mercuric chloride	+	Phenylhydrazine hydrochloride	+
Fruit juices and pulp	+	Mercuric cyanide	+	Phosgene gas	+
Furfural	-	Mercurous nitrate	+	Phosgene liquid	-
Gallic acid	+	Mercury	+	Phosphoric acid 10%	+
Glucose	+	Methyl alcohol	+	Phosphoric acid 85%	+
Glycerine	+	Methyl bromide	-	Phosphoric acid (yellow)	+
Glycol	+	Methyl chloride	-	Phosphorus pentachloride	+
Glycolic acid	+	Methyl methacrylate	-	Phosphorus trichloride	-
Heptane	+	Methylene chloride	-	Photographic solutions	+
Hexane	+	Methyl ethyl ketone	-	Pictic acid	-
Hexanol, tertiary	+	Methyl iso butyl ketone	-	Potassium alum	+
Hydrobromic acid 20%	+	Methyl sulphate	+	Potassium bicarbonate	+
Hydrochloric acid 10%	+	Methyl sulphuric acid	+	Potassium bichromate	+
Hydrochloric acid 35%	+	Milk	+	Potassium borate	+
Hydrocyanide acid	+	Mineral oils	+	Potassium bromate	+
Hydrofluoric acid 50%	+	Molasses	+	Potassium bromide	+
Hydrogen	+	Monochloroacetic acid	+	Potassium carbonate	+
Hydrogen peroxide 30%	+	Muriatic acid	+	Potassium chromate	+
Hydrogen peroxide 90%	+	Naphtha	+	Potassium chlorate	+
Hydrogen phosphide	+	Napthalene	-	Potassium chloride	+
Hydrogen sulphide	+	Natural gas	+	Potassium cyanide	+
Hydroquinone	+	Nickel chloride	+	Potassium dichromate	+

## CHEMICAL RESISTANCE

Potassium ferricyanide	+	Sodium sulphide	+
Potassium ferrocyanide	+	Sodium sulphite	+
Potassium fluoride	+	Stannic chloride	+
Potassium hydroxide	+	Stannous chloride	+
Potassium nitrate	+	Starch	+
Potassium perborate	+	Stearic acid	+
Potassium perchlorate	+	Sulphur	+
Potassium permanganate 10%	+	Sulphur dioxide (dry)	+
Potassium permanganate 25%	+	Sulphur dioxide (wet)	+
Potassium sulphate	+	Sulphur trioxide	+
Propane liquid	+	Sulphuric acid 3%	+
Propane gas	+	Sulphuric acid 70%	+
Propargyl alcohol	+	Sulphuric acid 80%	+
Propyl alcohol	+	Sulphuric acid 85%	-
Propylene dichloride	-	Sulphurous acid	+
Plating solutions	+	Tallow	+
Rochelle salts	+	Tall oil	+
Sea water	+	Tannic acid	+
Selenic acid	+	Tartaric acid	+
Sewage	+	Tetraethyl lead	+
Sillicic acid	+	Tetrahydrofurane	-
Silver cyanide	+	Thionyl chloride	-
Silver nitrate	+	Terpineol	+
Silver plating solution	+	Titanium tetrachloride	-
Silver sulphate	+	Tanning liquors	+
Soaps	+	Toluene	-
Sodium acetate	+	Transformer oil	+
Sodium alum	+	Tributyl phosphate	-
Sodium benzoate	+	Trichlorethylene	-
Sodium bicarbonate	+	Triethanolamine	+
Sodium bisulphate	+	Trimethyl propane	+
Sodium bisulphite	+	Trisodium phosphate	+
Sodium bromide	+	Turpentine	+
Sodium carbonate	+	Urea	+
Sodium chlorate	+	Urine	+
Sodium chloride	+	Water - deionized	+
Sodium cyanide	+	Water - distilled	+
Sodium dichromate	+	Water - demineralized	+
Sodium ferricyanide	+	Water - salt	+
Sodium ferrocyanide	+	Whiskey	+
Sodium fluoride	+	Wines	+
Sodium hydroxide 10%	+	Xylene	-
Sodium hydroxide 50%	+	Yeast	+
Sodium hypochlorite	+	Zinc chloride	+
Sodium nitrate	+	Zinc nitrate	+
Sodium peroxide	+	Zinc sulphate	+
Sodium sulphate	+		

# Contact Us

3893/1024

## Technical Enquiries

e: [bptechnical@brettmartin.com](mailto:bptechnical@brettmartin.com)

---

## England & Wales

Speedwell Ind. Estate  
Staveley, Derbyshire  
S43 3JP

t: 01246 280000

e: [building@brettmartin.com](mailto:building@brettmartin.com)

## Orderline

e: [bpsales@brettmartin.com](mailto:bpsales@brettmartin.com)

---

## Scotland

Blairlinn Road  
Cumbernauld, Glasgow  
G67 2TF

t: 01236 725536

e: [scotland@brettmartin.com](mailto:scotland@brettmartin.com)

---

## Ireland

24 Roughfort Road  
Mallusk, Co. Antrim  
BT36 4RB

t: 028 9084 999 (NI)

048 9084 9999 (ROI)

## Orderline

t: 028 9084 8999 (NI)

048 9084 8999 (ROI)

e: [sales@brettmartin.com](mailto:sales@brettmartin.com)

---

For the latest information visit

**[brettmartin.com](http://brettmartin.com)**



All reasonable care has been taken in the compilation of the information contained within this literature. All recommendations on the use of our products are made without guarantee as conditions of use are beyond the control of Brett Martin. It is the customer's responsibility to ensure that each product is fit for its intended purpose and that the actual conditions of use are suitable.

Brett Martin pursues a policy of continuous product development and reserves the right to amend specifications without prior notice.

Copyright Brett Martin Ltd

# Contact Us

3893/1024

## Technical Enquiries

e: [bptechnical@brettmartin.com](mailto:bptechnical@brettmartin.com)

---

## England & Wales

Speedwell Ind. Estate  
Staveley, Derbyshire  
S43 3JP

t: 01246 280000

e: [building@brettmartin.com](mailto:building@brettmartin.com)

## Orderline

e: [bpsales@brettmartin.com](mailto:bpsales@brettmartin.com)

---

## Scotland

Blairlinn Road  
Cumbernauld, Glasgow  
G67 2TF

t: 01236 725536

e: [scotland@brettmartin.com](mailto:scotland@brettmartin.com)

---

## Ireland

24 Roughfort Road  
Mallusk, Co. Antrim  
BT36 4RB

t: 028 9084 999 (NI)

048 9084 9999 (ROI)

## Orderline

t: 028 9084 8999 (NI)

048 9084 8999 (ROI)

e: [sales@brettmartin.com](mailto:sales@brettmartin.com)

---

For the latest information visit

**[brettmartin.com](http://brettmartin.com)**



All reasonable care has been taken in the compilation of the information contained within this literature. All recommendations on the use of our products are made without guarantee as conditions of use are beyond the control of Brett Martin. It is the customer's responsibility to ensure that each product is fit for its intended purpose and that the actual conditions of use are suitable.

Brett Martin pursues a policy of continuous product development and reserves the right to amend specifications without prior notice.

Copyright Brett Martin Ltd